

STRATHFIELD COUNCIL
RECEIVED
S8.2 DA2021.52
DATE 3 February 2022



Ref to Drawing L- 04

Ref to Drawing L- 03

Ref to Drawing L- 05

Ref to Drawing L- 02

EXISTING TREE LEGEND

- EXISTING TREES TO BE RETAINED
- EXISTING TREES TO BE REMOVED

LEGEND

- DRIVEWAY
- TURF AREAS
- DEEP SOIL GARDENS
- PROPOSED BUILDING
- TURF CELL
- PAVED TYPE 1
- PROPOSED LEVEL RL 32.80

The existing bird of paradise in the front garden/car park blisters and truck driveway to be relocated to embankment opposite existing loading dock W1.



ISSUE	DATE	COMMENT
H	27/01/22	DA ISSUE FOR REVIEW

GENERAL NOTES
All work to be carried out in accordance with the Building Code of Australia, all Local and State Government Ordinances, relevant Australian Standards, Local Authorities Regulations and all other relevant Authorities concerned.
All structural work and site drainage to be subject to Engineer's details or certification where required by Council. This shall include r.c. slabs and footings, r.c. and steel beams & columns, wind bracing to AS 1170
and AS4056, anchor rods or bolts, tie downs, fixings etc. Driveway slabs and drainage to Council's satisfaction. All timbers to be in accordance with SAA Timber Structure Code AS1720 and SAA Timber Framing Code AS 1884. All work to be carried out in a professional and workman- shiplike manner according to the plans and specification.
NOTE
Do not scale off the drawings unless otherwise stated and use figured dimensions in preference.
All dimensions are to be checked and verified on site before the commencement of any work. All dimensions and levels are subject to final survey and set-out
No responsibility will be accepted by SiteDesign for any variations in design, builder's method of construction or materials used, deviation from specification without permission or accepted work practices resulting in inferior construction. Locate and protect all services prior to construction.
COPYRIGHT CLAUSE
This drawing and design is the property of SiteDesign and should not be reproduced either in part or whole without the written consent of this firm.

SITEDSIGN +STUDIOS
creating places to live in and enjoy

CENTRAL COAST STUDIO
PO Box 312 Terrigal NSW 2260
p 1300 22 44 55
info@sdstudios.com.au
www.sdstudios.com.au

Project **PROPOSED INDUSTRIAL DEVELOPMENT**
Address **DAVIDSON ST, GREENACRE, NSW**
Drawing Title **LANDSCAPE PLAN**

Date **27/01/2022**
Scale **1:500@A1**

Drawing No. **1337**

Page
L-01 H

STRATHFIELD COUNCIL
RECEIVED
S8.2 DA2021.52
DATE 3 February 2022

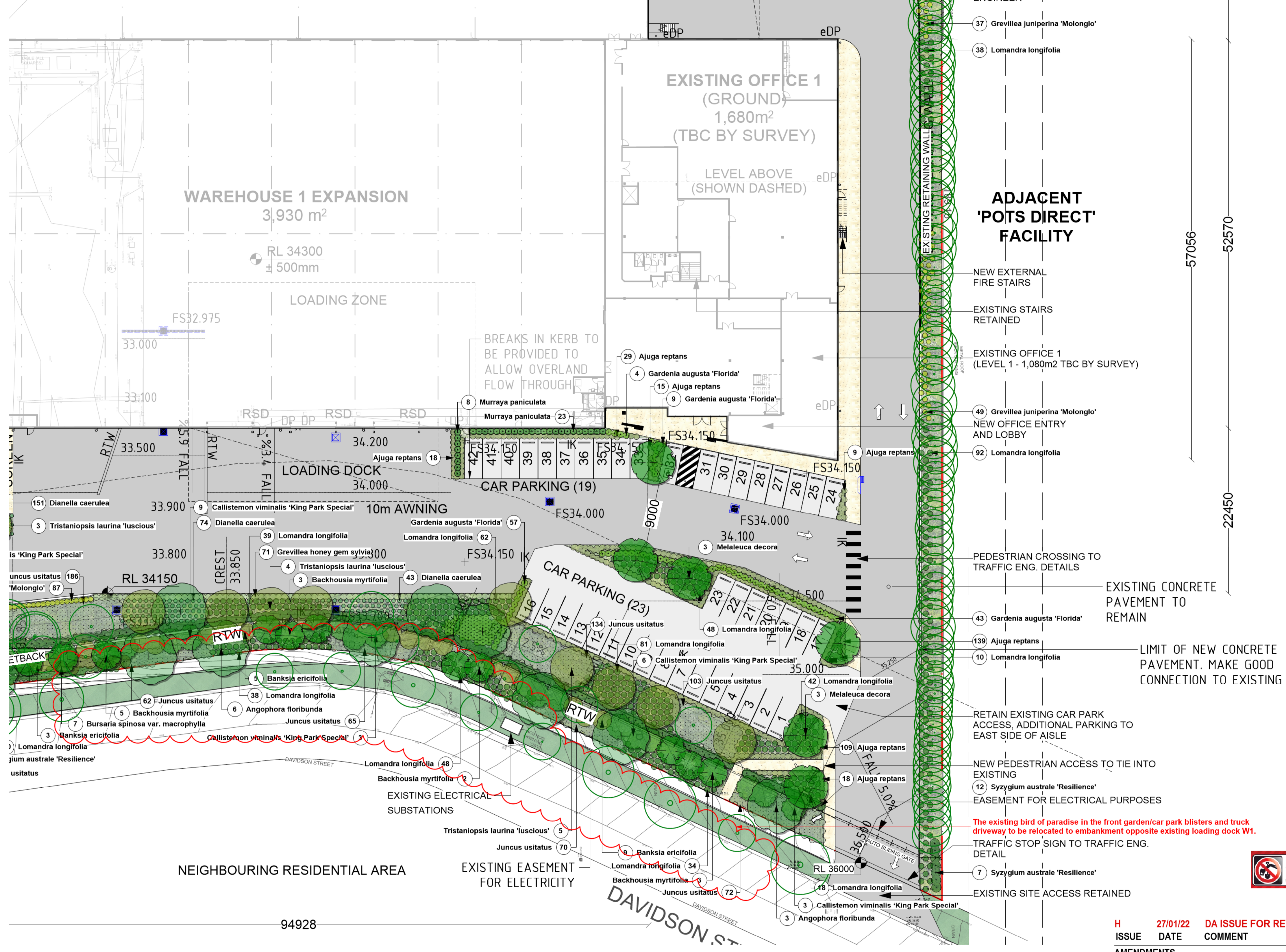

EXISTING TREE LEGEND

- EXISTING TREES TO BE RETAINED
- EXISTING TREES TO BE REMOVED

LEGEND

- DRIVEWAY
- TURF AREAS
- DEEP SOIL GARDENS
- PROPOSED BUILDING
- TURF CELL
- PAVED TYPE 1 (AS SUBMITTED TO THE COUNCIL FOR CONCRETE)
- PROPOSED LEVEL RL 32.80

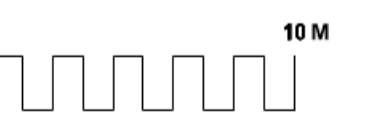

AMENDMENTS	ISSUE	DATE	COMMENT
H	27/01/22	DA ISSUE FOR REVIEW	

GENERAL NOTES
All work to be carried out in accordance with the Building Code of Australia, all Local and State Government Ordinances, relevant Australian Standards, Local Authorities Regulations and all other relevant Authorities concerned.
All structural work and site drainage to be subject to Engineer's details or certification where required by Council. This shall include r.c. slabs and footings, r.c. and steel beams & columns, wind bracing to AS 1170 and AS 4055, anchor rods or bolts, tie downs, fixings etc. Driveway slabs and drainage to Council's satisfaction. All timbers to be in accordance with SAA Timber Structure Code AS1720 and SAA Timber Framing Code AS 1884. All work to be carried out in a professional and workman-like manner according to the plans and specification.
NOTE
Do not scale off the drawings unless otherwise stated and use figured dimensions in preference.
All dimensions are to be checked and verified on site before the commencement of any work, all dimensions and levels are subject to final survey and set-out
No responsibility will be accepted by Sitedesign for any variations in design, builder's method of construction or materials used, deviation from specification without permission or accepted work practices resulting in inferior construction. Locate and protect all services prior to construction.
COPYRIGHT CLAUSE
This drawing and design is the property of Sitedesign and should not be reproduced either in part or whole without the written consent of this firm.

SITEDESIGN + STUDIOS
creating places to live in and enjoy

CENTRAL COAST STUDIO
PO Box 312 Terrigal NSW 2260
p 1300 22 44 55
info@sdstudios.com.au
www.sdstudios.com.au

Project **PROPOSED INDUSTRIAL DEVELOPMENT**
Address **DAVIDSON ST, GREENACRE, NSW**
Drawing Title **DETAIL PLAN 1**

Date **27/01/2022**
Scale **1:250@A1**

Drawing No. **1337**

Page **L-02 H**

STRATHFIELD COUNCIL
RECEIVED
S8.2 DA2021.52
DATE 3 February 2022

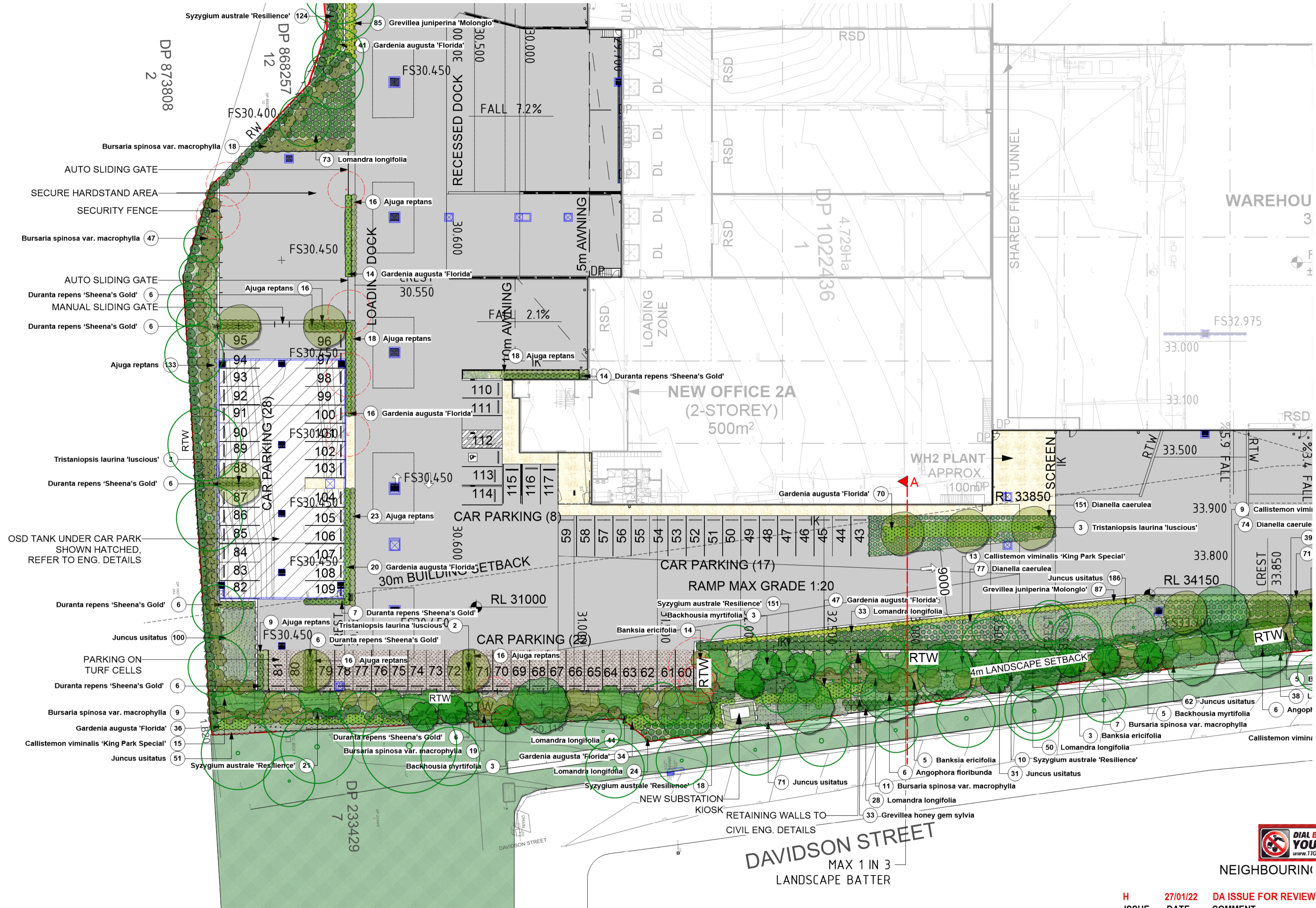

- EXISTING TREE LEGEND**
- EXISTING TREES TO BE RETAINED
 - EXISTING TREES TO BE REMOVED
- LEGEND**
- DRIVEWAY
 - TURF AREAS
 - DEEP SOIL GARDENS
 - PROPOSED BUILDING
 - TURF CELL
 - PAVED TYPE 1 (SUBJECT TO APPROVAL BY COUNCIL)
 - PROPOSED LEVEL RL 32.80

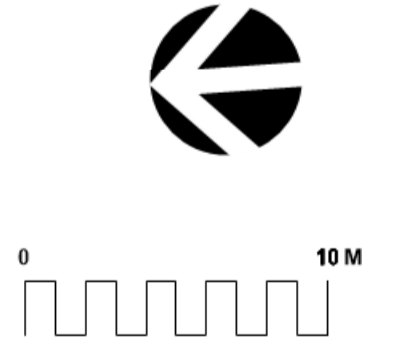

ISSUE	DATE	COMMENT
H	27/01/22	DA ISSUE FOR REVIEW

AMENDMENTS

GENERAL NOTES

All work to be carried out in accordance with the Building Code of Australia, all Local and State Government Ordinances, relevant Australian Standards, Local Authorities Regulations and all other relevant Authorities concerned.

All structural work and site drainage to be subject to Engineer's details or certification where required by Council. This shall include r.c. slabs and footings, r.c. and steel beams & columns, wind bracing to AS 1170 and AS4055, anchor rods or bolts, tie downs, fixings etc. driveway slabs and drainage to Council's satisfaction. All timbers to be in accordance with SAA Timber Structure Code AS1720 and SAA Timber Framing Code AS 1884. All work to be carried out in a professional and workman-like manner according to the plans and specification.

NOTE

Do not scale off the drawings unless otherwise stated and use figured dimensions in preference.

All dimensions are to be checked and verified on site before the commencement of any work, all dimensions and levels are subject to final survey and set-out.

No responsibility will be accepted by Sitedesign for any variations in design, builder's method of construction or materials used, deviation from specification without permission or accepted work practices resulting in inferior construction. Locate and protect all services prior to construction.

COPYRIGHT CLAUSE

This drawing and design is the property of Sitedesign and should not be reproduced either in part or whole without the written consent of this firm.

SITEDESIGN + STUDIOS
creating places to live in and enjoy

CENTRAL COAST STUDIO
PO Box 312 Terrigal NSW 2260
p 1300 22 44 55
info@sdstudios.com.au
www.sdstudios.com.au

Project PROPOSED INDUSTRIAL DEVELOPMENT
Address DAVIDSON ST, GREENACRE, NSW
Drawing Title DETAIL PLAN 2

Date 27/01/2022
Scale 1:250@A1

Drawing No. 1337

Page L-03 H

STRATHFIELD COUNCIL
RECEIVED
S8.2 DA2021.52
DATE 3 February 2022



EXISTING TREE LEGEND

EXISTING TREES TO BE RETAINED (Green circle)

EXISTING TREES TO BE REMOVED (Red circle)

LEGEND

- DRIVEWAY
- TURF AREAS
- DEEP SOIL GARDENS
- PROPOSED BUILDING
- TURF CELL
- PAVED TYPE 1 (AS PER SUBMITTED DRAWING OR CONCRETE)
- PROPOSED LEVEL RL 32.80

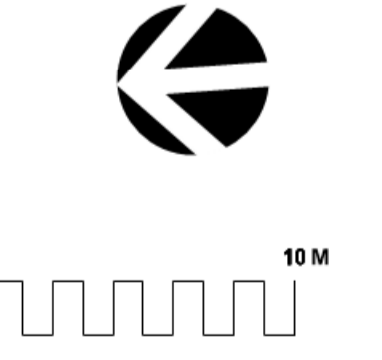

AMENDMENTS	ISSUE	DATE	COMMENT
H	27/01/22	DA ISSUE FOR REVIEW	

GENERAL NOTES

All work to be carried out in accordance with the Building Code of Australia, all Local and State Government Ordinances, relevant Australian Standards, Local Authorities Regulations and all other relevant Authorities concerned.

All structural work and site drainage to be subject to Engineer's details or certification where required by Council. This shall include r.c. slabs and footings, r.c. and steel beams & columns, wind bracing to AS 1170 and AS4055, anchor rods or bolts, tie downs, fixings etc. driveway slabs and drainage to Council's satisfaction. All timbers to be in accordance with SAA Timber Structure Code AS1720 and SAA Timber Framing Code AS 1684. All work to be carried out in a professional and workman- shiplike manner according to the plans and specification.

NOTE

Do not scale off the drawings unless otherwise stated and use figured dimensions in preference.

All dimensions are to be checked and verified on site before the commencement of any work. All dimensions and levels are subject to final survey and set-out.

No responsibility will be accepted by SiteDesign for any variations in design, builder's method of construction or materials used, deviation from specification without permission or accepted work practices resulting in inferior construction. Locate and protect all services prior to construction.

COPYRIGHT CLAUSE

This drawing and design is the property of SiteDesign and should not be reproduced either in part or whole without the written consent of this firm.

SITEDESIGN +STUDIOS
creating places to live in and enjoy

CENTRAL COAST STUDIO
PO Box 312 Terrigal NSW 2260
p 1300 22 44 55
info@sdstudios.com.au
www.sdstudios.com.au

Project **PROPOSED INDUSTRIAL DEVELOPMENT**
Address **DAVIDSON ST, GREENACRE, NSW**
Drawing Title **DETAIL PLAN 3**

Date **27/01/2022**
Scale **1:250@A1**

Drawing No. **1337**

Page
L-04 H

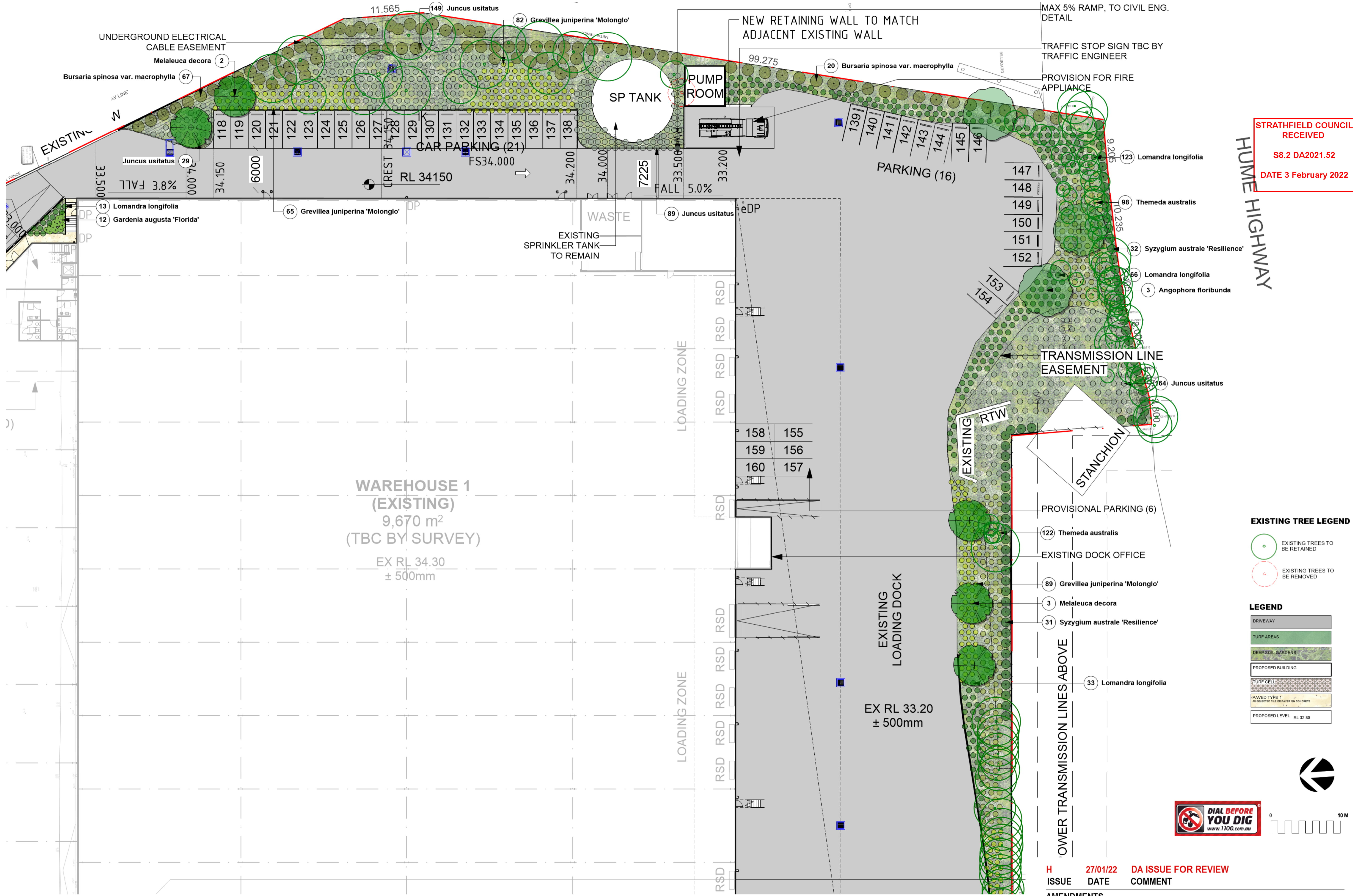

STRATHFIELD COUNCIL
RECEIVED
S8.2 DA2021.52
DATE 3 February 2022

EXISTING TREE LEGEND

EXISTING TREES TO BE RETAINED

EXISTING TREES TO BE REMOVED

LEGEND

DRIVEWAY

TURF AREAS

DEEP SOIL GARDENS

PROPOSED BUILDING

TURF CELL

PAVED TYPE 1

PROPOSED LEVEL RL 32.80

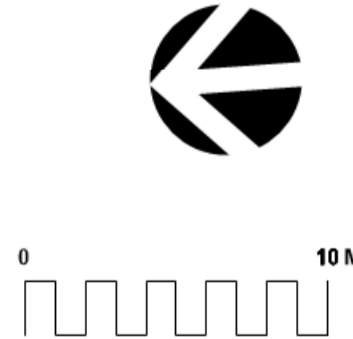

ISSUE	DATE	COMMENT
H	27/01/22	DA ISSUE FOR REVIEW

GENERAL NOTES

All work to be carried out in accordance with the Building Code of Australia, all Local and State Government Ordinances, relevant Australian Standards, Local Authorities Regulations and all other relevant Authorities concerned.

All structural work and site drainage to be subject to Engineer's details or certification where required by Council. This shall include r.c. slabs and footings, r.c. and steel beams & columns, wind bracing to AS 1170

All timbers to be in accordance with SAA Timber Structure Code AS1720 and SAA Timber Framing Code AS 1684. All work to be carried out in a professional and workman- shiplike manner according to the plans and specification.

NOTE

Do not scale off the drawings unless otherwise stated and use figured dimensions in preference.

All dimensions are to be checked and verified on site before the commencement of any work. All dimensions and levels are subject to final survey and set-out

No responsibility will be accepted by Sitedesign for any variations in design, builder's method of construction or materials used, deviation from specification without permission or accepted work practices resulting in inferior construction. Locate and protect all services prior to construction.

COPYRIGHT CLAUSE

This drawing and design is the property of Sitedesign and should not be reproduced either in part or whole without the written consent of this firm.

SITEDESIGN +STUDIOS
creating places to live in and enjoy

CENTRAL COAST STUDIO
PO Box 312 Terrigal NSW 2260
p 1300 22 44 55
info@sdstudios.com.au
www.sdstudios.com.au

Project **PROPOSED INDUSTRIAL DEVELOPMENT**

Address **DAVIDSON ST, GREENACRE, NSW**

Drawing Title **DETAIL PLAN 4**

Date **27/01/2022**

Scale **1:250@A1**

Drawing No. **1337**

Page **L-05 H**

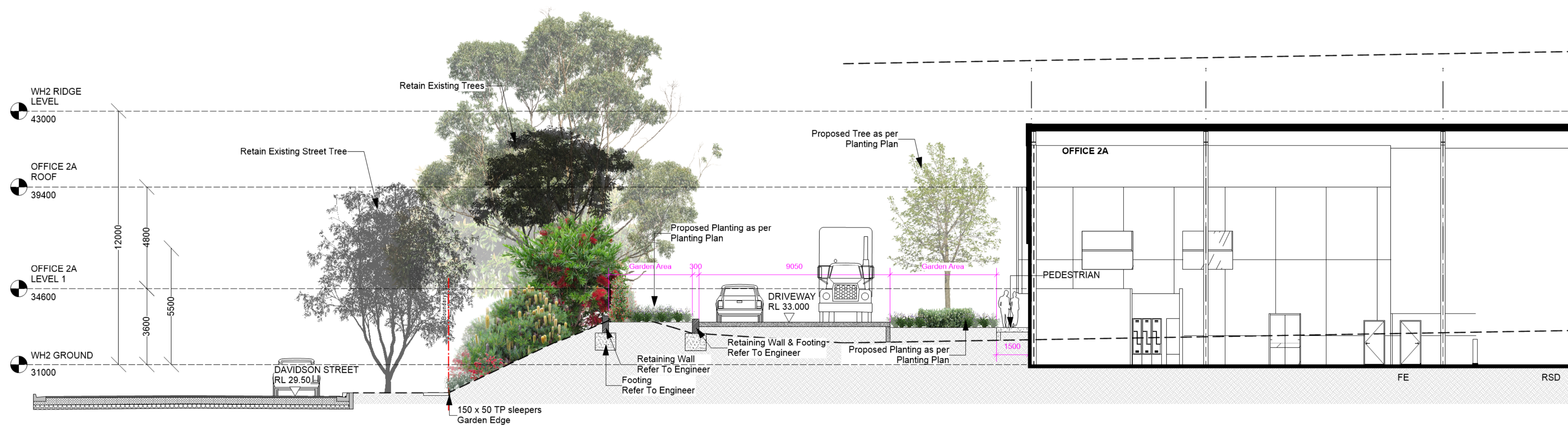

1 SECTION A
Scale: 1:100

ISSUE	DATE	COMMENT
H	27/01/22	DA ISSUE FOR REVIEW

AMENDMENTS

GENERAL NOTES
 All work to be carried out in accordance with the Building Code of Australia, all Local and State Government Ordinances, relevant Australian Standards, Local Authorities Regulations and all other relevant Authorities concerned.
 All structural work and site drainage to be subject to Engineer's details or certification where required by Council. This shall include r.c. slabs and footings, r.c. and steel beams & columns, wind bracing to AS 1170 and AS4055, anchor rods or bolts, tie downs, fixings etc. driveway slabs and drainage to Council's satisfaction. All timbers to be in accordance with SAA Timber Structure Code AS1720 and SAA Timber Framing Code AS 1684. All work to be carried out in a professional and workman- shiplike manner according to the plans and specification.
 NOTE
 Do not scale off the drawings unless otherwise stated and use figured dimensions in preference.
 All dimensions are to be checked and verified on site before the commencement of any work, all dimensions and levels are subject to final survey and set out
 No responsibility will be accepted by Sitedesign for any variations in design, builder's method of construction or materials used, deviation from specification without permission or accepted work practices resulting in inferior construction. Locate and protect all services prior to construction.
 COPYRIGHT CLAUSE
 This drawing and design is the property of Sitedesign and should not be reproduced either in part or whole without the written consent of this firm.



CENTRAL COAST STUDIO
 PO Box 312 Terrigal NSW 2260
 p 1300 22 44 55
 info@sdstudios.com.au
 www.sdstudios.com.au

Project	PROPOSED INDUSTRIAL DEVELOPMENT
Address	DAVIDSON ST, GREENACRE, NSW
Drawing Title	SECTION A

Date 27/01/2022
 Scale 1:100@A1

Drawing No. 1337



ID	Qty	Common Name	Botanical Name	Scheduled Size	Mature Height	Mature Spread
Trees						
AF	18	Rough-barked Apple	Angophora floribunda	45L	10 - 15m	6 - 10m
Bac-my	19	Grey Myrtle	Backhousia myrtifolia	45L	8m	4m
cal-vim'kp'	49	Weeping Bottlebrush	Callistemon viminalis 'King Park Special'	45L	3 - 5m	3.5 - 6m
ML	11	White Feather Honeymyrtle	Melaleuca decora	45L	5 - 10m	6 - 10m
TLaur-lus	17	Kanooka, Water Gum	Tristaniopsis laurina 'luscious'	45L	5 - 10m	3.5 - 6m
Shrubs						
Ban-eri	36	Heath-leaved Banksia	Banksia ericifolia	200mm	3 - 5m	3.5 - 6m
bur-spi	234	Sweet Bursaria	Bursaria spinosa var. macrophylla	150mm	3 - 5m	2.0 - 3.5m
dur-re'sg'	63	Sheena's Gold	Duranta repens 'Sheena's Gold'	150mm	0.8 - 2m	1m
Gar-aug-fl	628	Gardenia	Gardenia augusta 'Florida'	150mm	1m	1m
gre-ho	104	Grevillea Honey Barbara	Grevillea honey gem sylvia	200mm	1 - 2m	1m
Gre-jun'Mo'	567	Grevillea molongio	Grevillea juniperina 'Molongio'	150mm	0.0 - 1 m	2 m
Mur-pan	167	Orange Jessamine	Murraya paniculata	150mm	1.5 - 3m	3.5 - 6m
syz-au're'	406	Lilly Pilly	Syzygium australe 'Resilience'	150mm	1 - 2.5m	1.5m
Ground Covers						
Aju-rep	602	Bugle, Wild Mint	Ajuga reptans	100mm	0.0 - 0.3m	0.6 - 0.9m
Grasses						
Dia-cae	522	Blue Flax-lily	Dianella caerulea	150mm	0.4m	0.6m
jun-us	1686	tussock grass	Juncus usitatus	150mm	1m	0.8m
Lom-ion	1187	Spiny-headed Mat-Rush	Lomandra longifolia	150mm	0.6m	1.0m
The-aus	220	Kangaroo Grass	Themeda australis	150mm	0.9 - 1.5m	0.3 - 0.6m
Total	6536					

MONTH	MOWING (WEEKLY)	FERT. LIQUID (WEEKLY)	CHECK (WEEKLY)	WEED (WEEKLY)	PRUNING (WEEKLY)	WATER (WEEKLY)	PLANT REPLACEMENT IF REQUIRED
DEC	W	M	M	W	F	M	D
JAN	W	M	M	W	F	M	D
FEB	W	M	M	W	F	M	D
MAR	F	M	M	F	M	M	D
APR	F	N/A	M	F	M	M	D
MAY	F	N/A	M	M	M	M	D
JUNE	M	N/A	M	M	N/A	N/A	2ND D
JULY	M	N/A	M	M	N/A	N/A	2ND D
AUG	M	N/A	M	M	N/A	N/A	2ND D
SEP	M	M	M	M	N/A	N/A	2ND D
OCT	F	F	M	F	M	M	D
NOV	F	F	M	F	M	M	D

MAINTENANCE GENERAL NOTES

SECTION C: LANDSCAPE MAINTENANCE SPECIFICATION 1.0 SCOPE

1.1 PERIOD
The 52 week Planting Establishment Period commences at the date of registration of the respective plan. The contractor is to also allow for maintenance from the date of Practical Completion to the start date of the 52 week Planting Establishment Period. The allowance shall be for a weekly rate which will then be implemented until the formal maintenance period commences.

1.2 PROGRAM
Furnish a proposed planting maintenance program with the tender.

1.3 MAINTENANCE LOGBOOK
Contractor to keep a maintenance record of works carried out on a monthly basis. Log should include but not limited to:
- Activities carried out during each attendance;
- Irregularities encountered and actions taken;
NB: Maintenance payments will be evaluated on submission of monthly logbooks.

1.4 RECURRENT WORKS
Throughout the Planting Establishment Period, continue to carry out recurrent works of a maintenance nature including, but not limited to, watering, mowing, weeding, rubbish removal, fertilising, pest and disease control, staking and tying, replanting, cultivating, pruning and keeping the site neat and tidy. All rubbish related to landscape works shall be removed by the landscape contractor before it is allowed to accumulate.

1.5 PLANTING
Commence recurrent planting maintenance works at the completion of planting. Ensure the stock arriving on site is protected and maintained for healthy growth.

1.6 REPLACEMENTS
Continue to replace failed, damaged or stolen plants for the extent of the Planting Establishment Period.

1.7 MULCHED SURFACES
Maintain the surface in a clean and tidy condition and reinstate the mulch to be standard hard wood chip as necessary.

1.8 GRASSED AREAS
Commence grass maintenance works at the completion of turfing, and continue to carry out grass maintenance throughout the contract and Planting Establishment Period, maintaining healthy weed free growth.

1.9 STAKES AND TIES
Adjust or replace as required. Remove those not required at the end of the Planting Establishment Period.

1.10 WATERING/IRRIGATION
An irrigation system is to be installed to all mass planted beds and new tree planting, connected to a pump and the rainwater tank / OSD tank. Install one tap near the front boundary (Wurrook Circuit) and one tap on the rear (eastern) boundary. This system shall be installed and maintained for the duration of the maintenance period (52 weeks) and in perpetuity of the development. All irrigation works shall be performed by a licensed irrigation contractor. Materials to be used are to be submitted to the site superintendent for approval. The contractor shall provide design drawings and material specifications/samples prior to commencing work. All works are to be conducted to all current and relevant Australian Standards. The contractor is to be completely responsible for the coordination of the installation of the irrigation system with other services throughout the site. Recommended flow rates. The system shall be set up on a trial basis and then adjusted to suit the local requirements and conditions. Once the system is satisfactorily adjusted the contractor shall make fortnightly visits within the establishment period to ensure satisfactory performance of the system and to adjust the watering periods as required. A minimum even coverage of 25mm of water per week is recommended.

2.0 REPORTS

2.1 LANDSCAPE MAINTENANCE REPORT
Landscape Maintenance Reports shall be submitted to the Principle Certifying Authority by the contractor verifying that satisfactory maintenance of the landscape works has been undertaken and that any necessary rectification measures have been carried out to a high professional standard. This documentation is to be submitted through the plant establishment period.

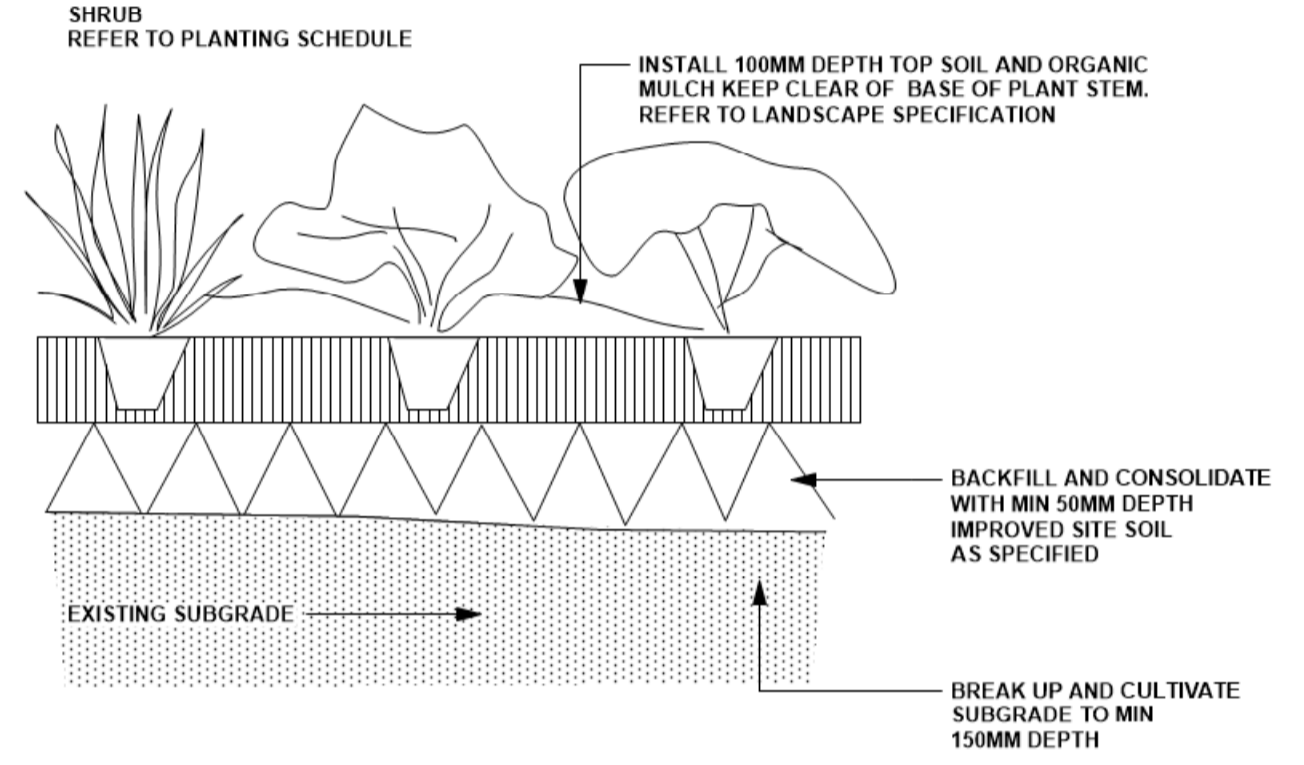

TYPICAL SHRUB PLANTING DETAIL

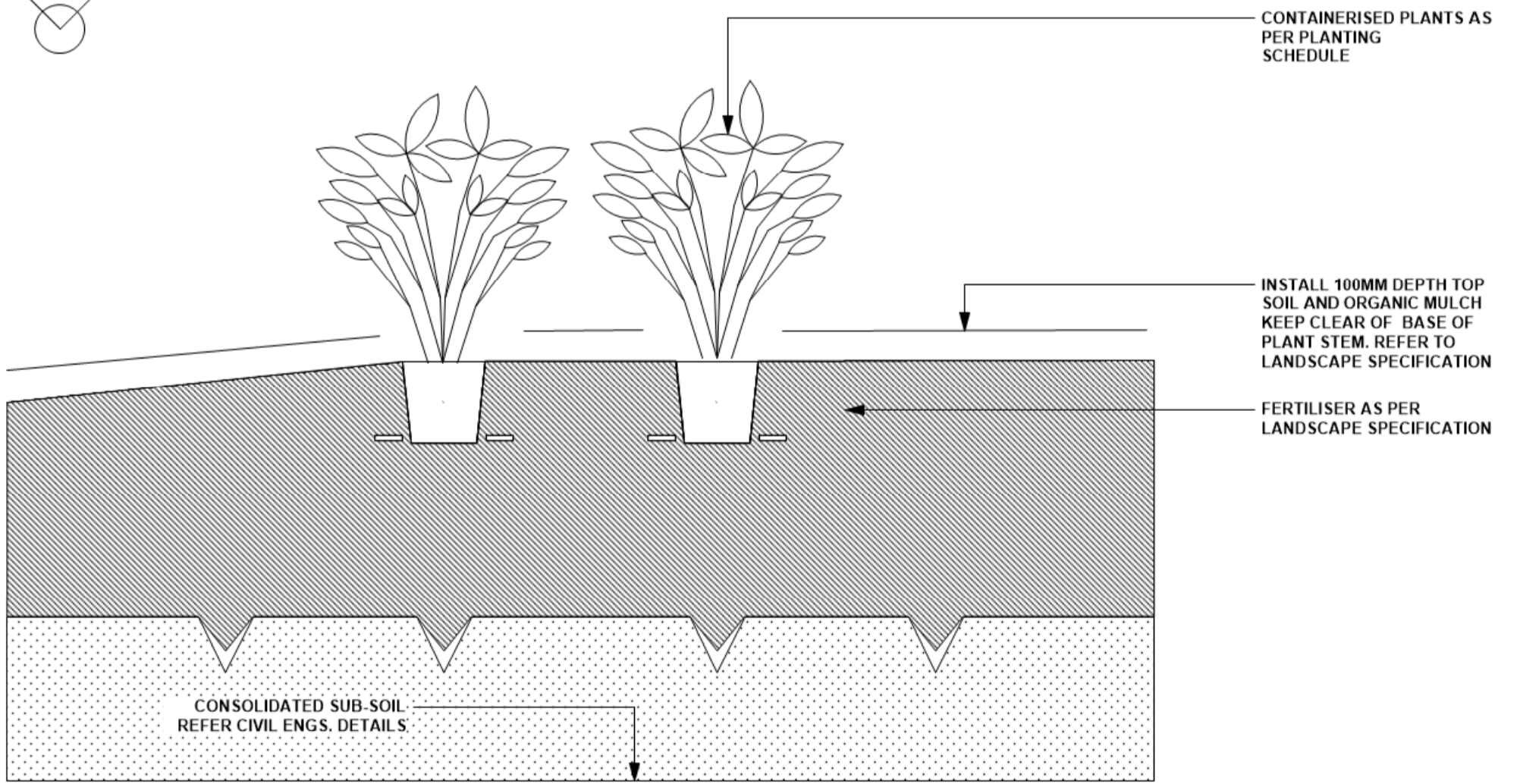
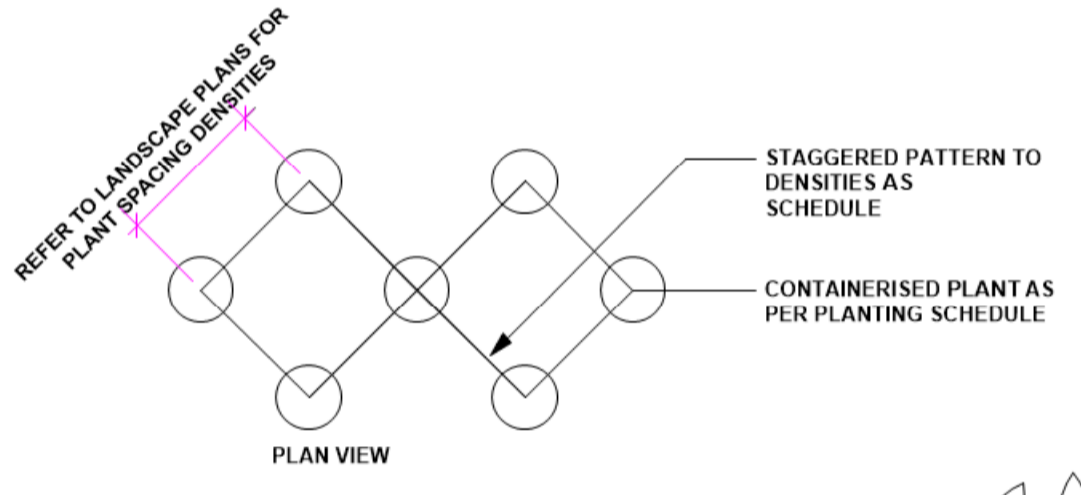

TYPICAL GROUND COVER PLANTING DETAIL

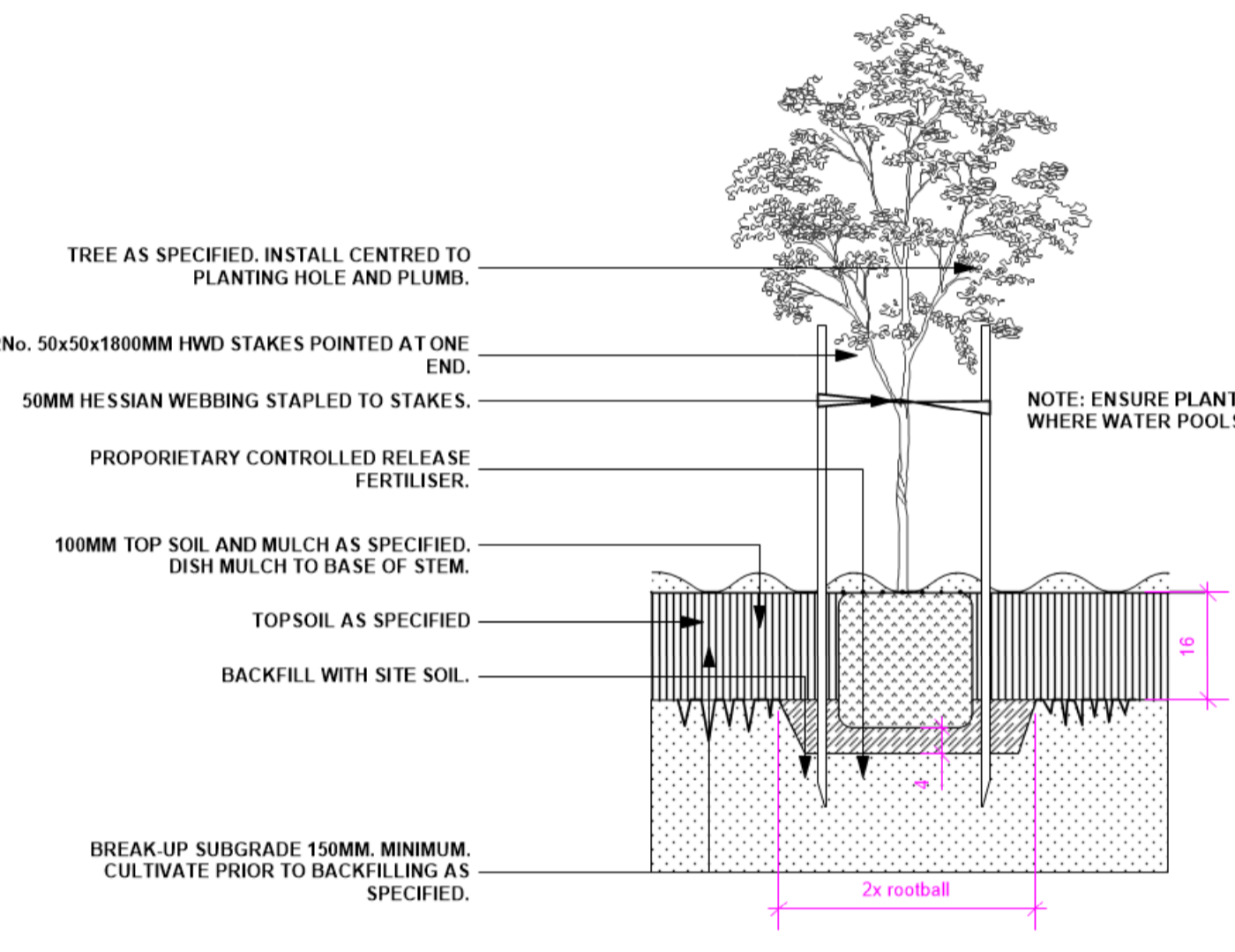

75-100L TREE PLANTING DETAIL

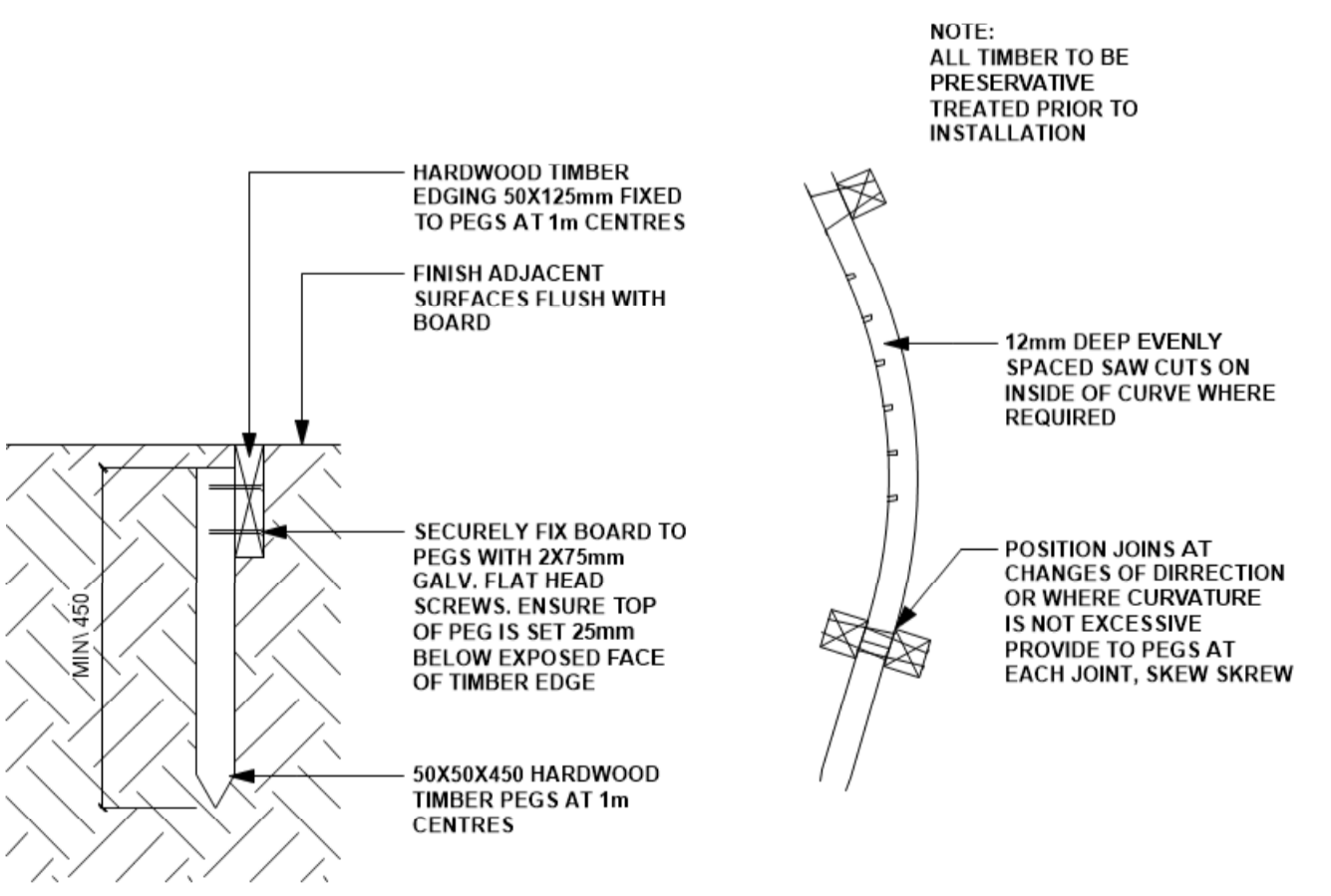

TIMBER EDGE

GENERAL NOTES
All work to be carried out in accordance with the Building Code of Australia, all Local and State Government Ordinances, relevant Australian Standards, Local Authorities Regulations and all other relevant Authorities concerned.
All structural work and site drainage to be subject to Engineer's details or certification where required by Council. This shall include r.c. slabs and footings, r.c. and steel beams & columns, wind bracing to AS 1170 and AS4056, anchor rods or bolts, tie-downs, fixings etc. driveway slabs and drainage to Council's satisfaction. All timbers to be in accordance with SAA Timber Structure Code AS1720 and SAA Timber Framing Code AS 1684. All work to be carried out in a professional and workman-like manner according to the plans and specification.
NOTE
Do not scale off the drawings unless otherwise stated and use figured dimensions in preference.
All dimensions are to be checked and verified on site before the commencement of any work. All dimensions and levels are subject to final survey and set-out
No responsibility will be accepted by Sitedesign for any variations in design, builder's method of construction or materials used, deviation from specification without permission or accepted work practices resulting in inferior construction. Locate and protect all services prior to construction.
COPYRIGHT CLAUSE
This drawing and design is the property of Sitedesign and should not be reproduced either in part or whole without the written consent of this firm.



CENTRAL COAST STUDIO
PO Box 312 Terrigal NSW 2260
p 1300 22 44 55
info@sdstudios.com.au
www.sdstudios.com.au

Project PROPOSED INDUSTRIAL DEVELOPMENT
Address DAVIDSON ST, GREENACRE, NSW
Drawing Title PLANTING DETAILS

H 27/01/22 DA ISSUE FOR REVIEW
ISSUE DATE COMMENT

AMENDMENTS

Date 27/01/2022
Scale N.T.S@A1

Drawing No. 1337

Page L-07 H