

STRATHFIELD COUNCIL  
RECEIVED  
DA2020/227 10  
December 2020

EASTBOURNE ROAD

▲ BM SSM64832  
RL 20.18

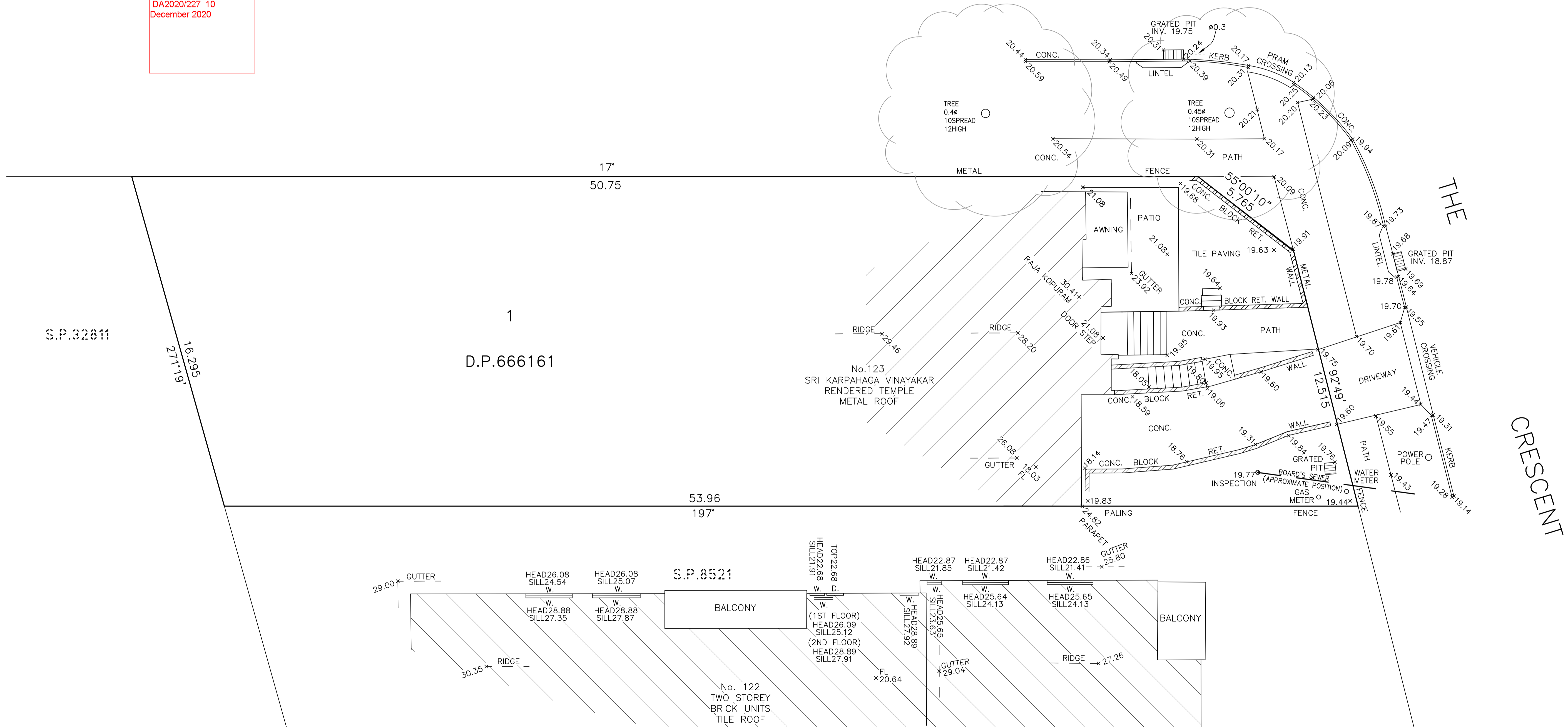

NOTES:

1. BEARINGS AND DISTANCES ARE BY TITLE ONLY. AREA IS BY CALCULATION FROM TITLE DIMENSIONS. IF THE AREA IS CRITICAL TO DESIGN FURTHER SURVEY SHOULD BE CARRIED OUT TO CONFIRM IT.
2. POSITION OF IMPROVEMENTS AND FENCES IN RELATION TO BOUNDARIES IS DIAGRAMMATIC ONLY EXCEPT WHERE BOUNDARY OFFSETS ARE SHOWN. IF FUTURE DEVELOPMENT IS CONTEMPLATED ON OR NEAR BOUNDARIES OF THE SUBJECT LAND, A FURTHER SURVEY SHOULD BE MADE TO MARK THOSE BOUNDARIES.
3. NO INVESTIGATION OF UNDER GROUND SERVICES HAS BEEN MADE. RELEVANT AUTHORITY SHOULD BE CONTACTED TO ESTABLISH DETAILED LOCATION AND DEPTH PRIOR TO ANY DEMOLITION, EXCAVATION OR CONSTRUCTION.
4. CONTOURS ARE INDICATIVE OF GROUND FORM ONLY.
5. DRAWING INTERCHANGE FILE (.DXF) FORMAT AVAILABLE.
6. AUSTRALIAN HEIGHT DATUM WAS ESTABLISHED FROM SSM64832 RL20.175 (A.H.D.).

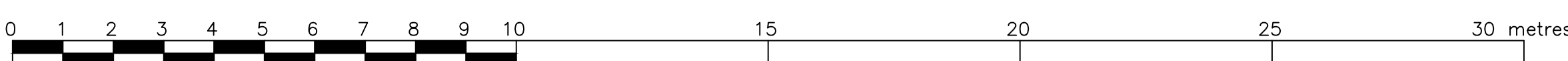
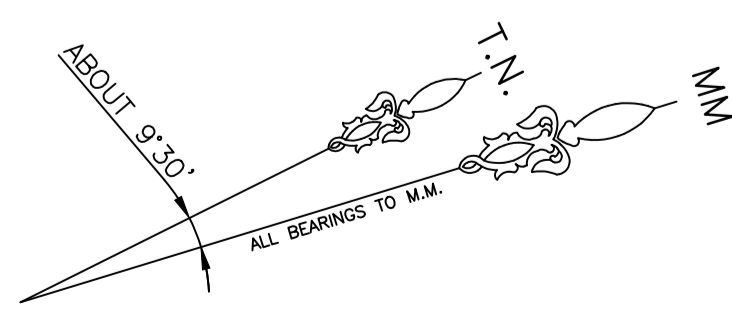

<p><b>M. Y. XU &amp; Co.</b> SURVEYORS &amp; DEVELOPMENT CONSULTANTS A. B. N. 82 357 803 551 162 Murray Farm Road, Beecroft NSW 2119 Telephone: (02) 8812 3029 Facsimile: (02) 8812 3680 E-Mail: land@landmarksurveyors.com.au</p>	CLIENT: SRI KARPAHAGA VINAYAKAR TEMPLE	
	SHEET 1 OF 1	
	PLAN OF PARTIAL DETAIL & LEVELS OVER LOT 1 IN D.P.666161 BEING No.123 THE CRESCENT, HOMEBUSH	
Registered Surveyor: Martin Y. Xu Surveyor ID: 5501	REF.: 12215-T7 SURVEY DATE: 27/08/2020	SCALE: 1:100 ON A1 DATUM: A.H.D. DATE MODIFIED: 15/09/2020