

EASTBOURNE ROAD

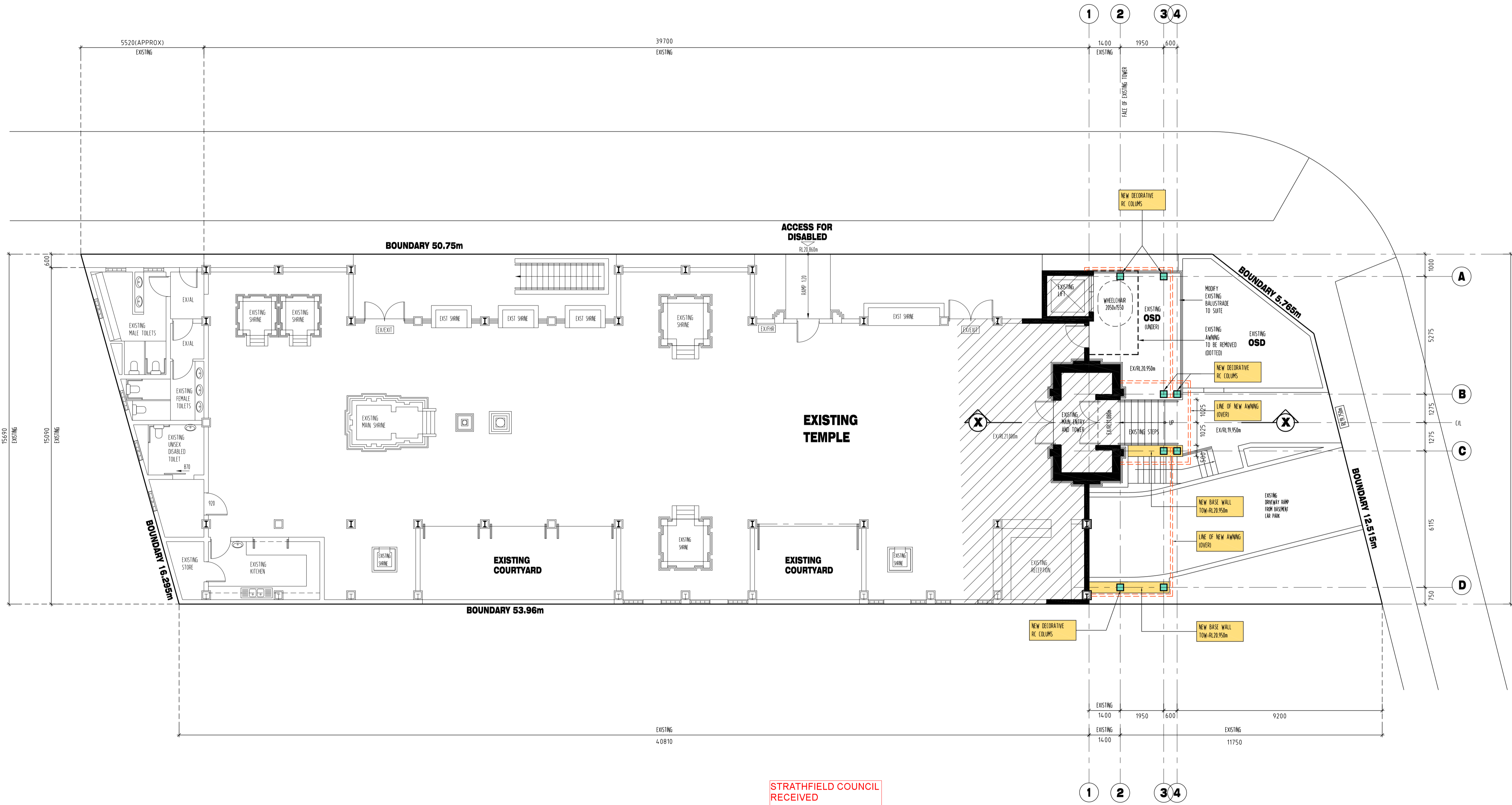

STRATHFIELD COUNCIL
RECEIVED

DA2020/227 10
December 2020

FLOOR PLAN
SCALE 1:100 (A1)

THIS DRAWING AND DESIGN IS SUBJECT TO COPYRIGHT AND MAY NOT BE REPRODUCED WITHOUT PRIOR WRITTEN CONSENT. ALL DIMENSIONS TO BE VERIFIED ON SITE PRIOR TO COMMENCEMENT OF ANY WORK. ANY DISCREPANCIES TO BE REFERRED TO THE ARCHITECT.

DATE	DESCRIPTION	ISSUE
01.05.20	DA SUBMISSION DRAWINGS	1

LEGEND

- EXISTM EXISTING FIRE HOSE REEL
- EXISTE EXISTING EXIT SIGN

THE CRESCENT

PROPOSED AWNING AT THE FRONT MAIN ENTRY TO AN EXISTING HINDU TEMPLE AT 123 THE CRESCENT, HOMEBUSH WEST, NSW 2140. FOR 'SYDNEY SRI KARPHAGA VINAYAKAR TEMPLE'

LOT-1, DP-666161

FLOOR PLAN

Architects:
 ARCHITECTS
D+C CONSORTIUM PTY LTD.
 7 CHILWORTH CLOSE, M-0416 085 676
 BEECROFT, NSW 2119, P-02 9980 8819
 AUSTRALIA, E-kuno@dccconsortium.com.au

Architect: Kuna Sivasamy, RAlA, Regd No-5989	Scale: 1:100(A1)	Date: 09.11.2020
Project No: 2016-22-AWN	Drawing No: DA-01	Issue: 1