

IDAP REPORT

Property:	10 Cameron Street STRATHFIELD Lot 46 DP 7837 DA2021.192
Proposal:	Construction of a front fence with gates.
Applicant:	FCG Landscaping
Owner:	Vincent Huang
Date of lodgement:	16 August 2021
Notification period:	N/A
Submissions received:	N/A
Assessment officer:	L Fanayan
Estimated cost of works:	\$19,000.00
Zoning:	R2-Low Density Residential - SLEP 2012
Flood affected:	Yes
RECOMMENDATION OF OFFICER:	APPROVAL



Figure 1: Locality Plan showing subject site (outlined in yellow) and surrounding properties

EXECUTIVE SUMMARY

Proposal

Development consent is being sought for the Construction of a front fence with gates.

Site and Locality

The site is identified as 10 Cameron Street Strathfield and has a legal description of Lot 46 DP 7837. The site is a regular shaped parcel of land and is located on the southern side of Cameron Street.

The site has a width of 14.63m, a depth of 38.4m and an overall site area of 556.4m².

The locality surrounding the subject site contains a mixture of low density residential development. Architectural styles vary and therefore a variety of front fencing occurs.

Strathfield Local Environmental Plan

The site is zoned R2-Low Density Residential under the provisions of Strathfield LEP 2012 and the proposal is a permissible form of development with Council's consent. The proposal satisfies all relevant objectives contained within the LEP.

Development Control Plan

The proposed development generally satisfies the provisions of Strathfield Consolidated DCP 2005. This is discussed in more detail in the body of the report.

Notification

The application was not notified.

Issues

- Fence height
- Flooding

Conclusion

Having regards to the heads of consideration under Section 4.15 of the Environmental Planning and Assessment Act 1979, Development Application 2021/192 is recommended for approval subject to suitable conditions of consent.

REPORT IN FULL

Proposal

Council has received an application for the Construction of a front fence with gates. More specifically, the proposal includes;

- Pedestrian gate and access
- Driveway gate and access
- Pillar height 1.5m
- Solid component is 0.55m
- Pillars are 0.45m wide
- Six (6) pillars along the front boundary
- Three (3) pillars along the side boundary on both sides.

The proposal does not include any landscaping.

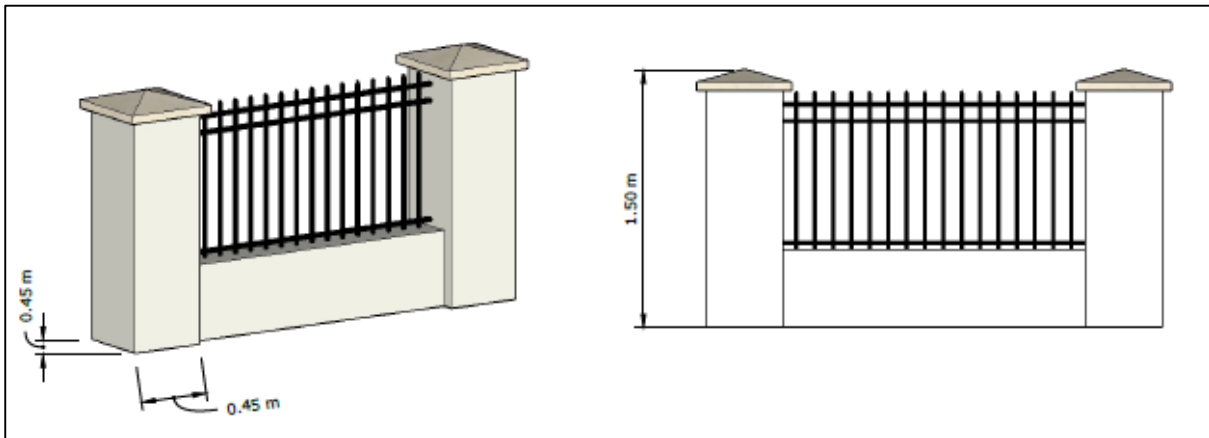

Figure 2: Front fence component elevation

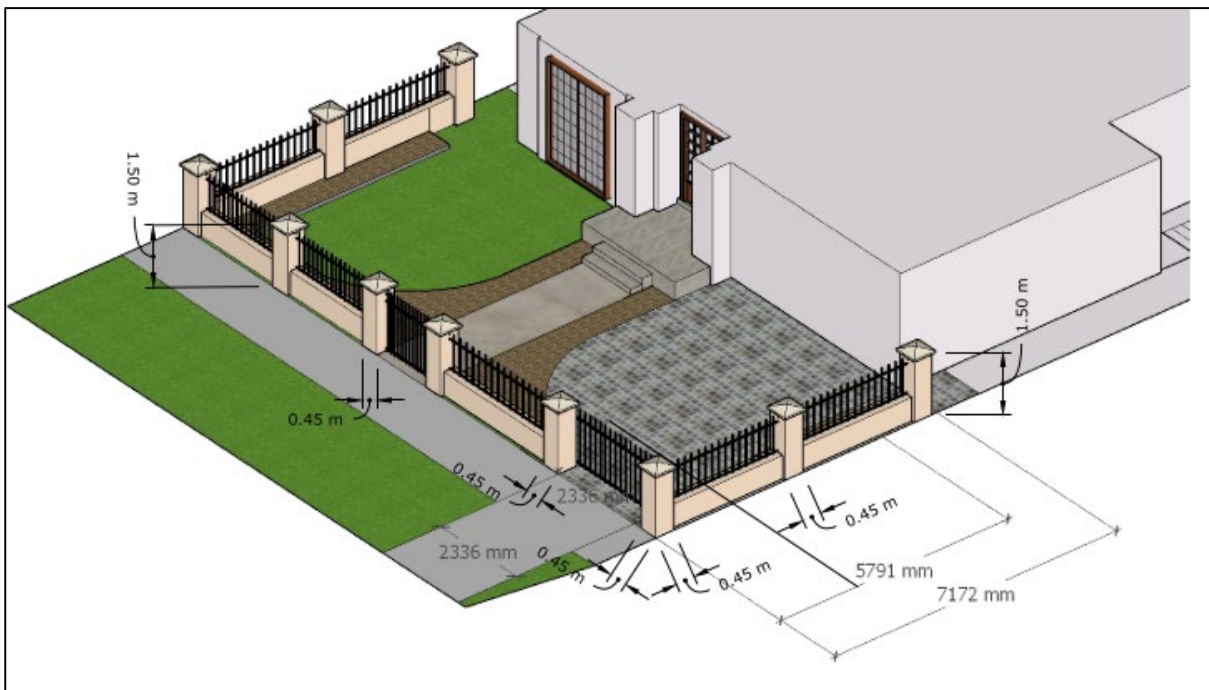

Figure 3: Fence design and location

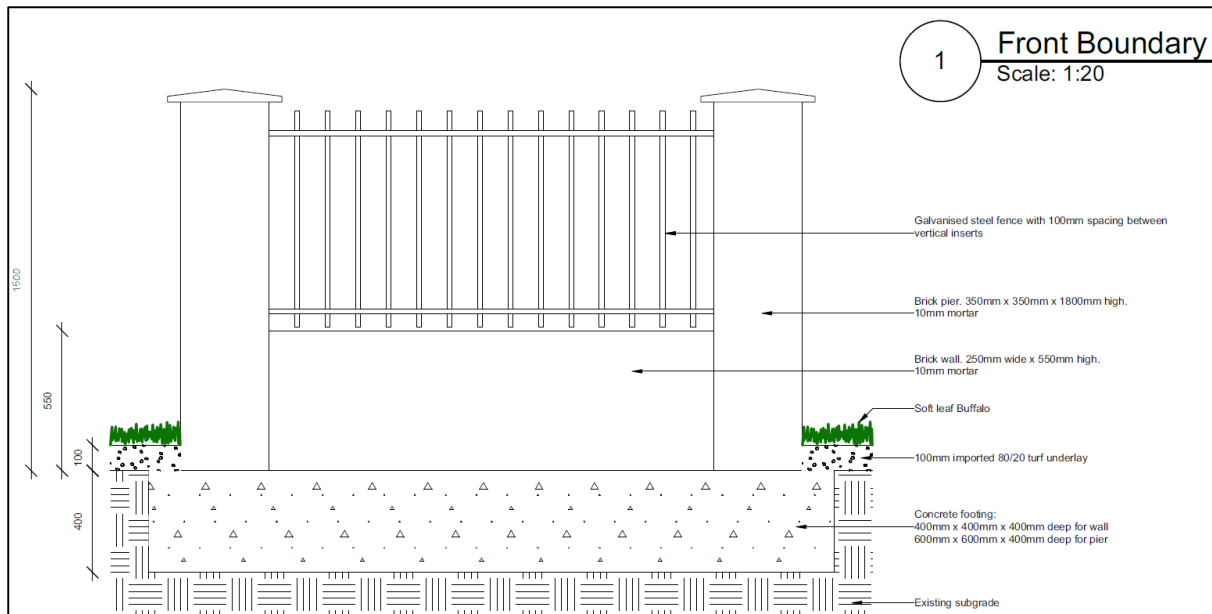

Figure 4: Fence detail

The Site and Locality

The subject site is legally described as Lot: 46 DP: 7837 and commonly known as 10 Cameron Street STRATHFIELD. It is located off the southern side of Cameron Street between The Boulevard and Kingsland Road.

The site is rectangular in shape and has a frontage of 14.63m to the north and a side boundary length of 38.4m and an area of 556.4m².

The site slopes from east to west and has a cross-fall of 0.5m over the width of the site.

The site is occupied by a two (2) storey dwelling. Vehicular access is provided to the site via an existing driveway from Cameron Street to an existing garage.

The current streetscape is characterised by low density residential dwellings. Architectural styles vary, thus a variety of front fencing occurs.



Figure 5: Site photo showing, from left to right, No. 8, No. 10 and No. 12 front fences/elevations.



Figure 6: Site photo looking down Cameron Street, outside N0 10 Cameron Street.



Figure 7: Site photo of No. 11, N0. 9 and No. 7 Cameron Street, across the road from No. 10 Cameron Street

Background

- | | |
|--------------------------|--|
| 13 September 2019 | DA2019/062 was approved for the construction of a two (2) storey dwelling and associated landscaping. |
| 20 December 2019 | DA2021/140 was approved for construction of a swimming pool, alfresco area and associated landscaping. |
| 10 January 2020 | DA2019/062/2 was approved to update conditions relating to the flood risk report. |
| 16 August 2021 | The subject application was lodged. |
| 31 August 2021 | A Request for Further Information letter was sent to the applicant raising the following issues: |

- Fence Height
- Landscape Plan
- Statement of Environmental Effects

9 September 2021 A site visit was undertaken by Council Ranger on behalf of Assessing Officer. Photos were sent to Assessing Officer. This process is due to the COVID-19 restrictions that limited movement out of other LGAs and into Strathfield LGA.

18 September 2021 The applicant provided additional information to address the issues raised in the letter.

29 September 2021 **A discussion with the** Applicant was had in regard to the detail of the plans provided and was asked to provide further detail. Applicant provided updated plans showing gates and further dimensions.

Referrals – Internal and External

Development Engineer Comments

Advice was sought from Council's Development Engineer regarding the flood affectation of the site and whether the solid fence design restricted overland flow. The advice provided was that:

Solid fences are appropriate as the flood flow path travels across the site, from side boundary to side boundary.

Section 4.15 Assessment – EP&A Act 1979

The following is an assessment of the application with regard to Section 4.15 (1) of the Environmental Planning and Assessment Act 1979.

(1) *Matters for consideration – general*

In determining an application, a consent authority is to take into consideration such of the following matters as are of relevance to the development the subject of the development application:

- (a) *the provision of:***
- (i) *any environmental planning instrument,***

Strathfield Local Environmental Plan

The development site is subject to the Strathfield Local Environmental Plan 2012

Part 2 – Permitted or Prohibited Development

Clause 2.1 – Land Use Zones

The subject site is zoned R2-Low Density Residential and the proposal is a permissible form of development with Council's consent.

Part 4 – Principal Development Standards

There are no provisions under this part which are relevant to the application.

Part 5 – Miscellaneous Provisions

Flood Planning

The subject site has been identified as being at or below the flood planning level. The application has been reviewed by Council's Engineer who has advised that subject to suitable conditions, the development is considered compatible with the flood hazard of the land, will not result in significant adverse effects on flood behaviour or environment and is not likely to result in unsustainable social and economic loss. The proposed development is considered to satisfy the objectives of this clause.

Part 6 – Additional Local Provisions

Acid Sulfate Soils

The subject site is identified as having Class 5 Acid Sulfate Soils but is not located within 500m of a Class 1, 2 3 or 4 soils. Therefore, Development Consent under the provisions of this section is not required and as such an Acid Sulfate Soils Management Plan is not required.

Earthworks

The proposal does not include any significant excavation or basement works. Any excavation for footings or levelling of the site is considered to be minor and will not have a detrimental impact on environmental functions and processes, neighbouring uses, cultural or heritage items or features of the surrounding land.

STATE ENVIRONMENTAL PLANNING POLICY (BUILDING SUSTAINABILITY INDEX: BASIX) 2004

As the value of works is less than \$50,000 or based on the nature of the development type, there is no requirement for the application to be assessed in accordance with the BASIX SEPP.

STATE ENVIRONMENTAL PLANNING POLICY NO. 55 – REMEDIATION OF LAND (SEPP 55)

SEPP 55 applies to the land and pursuant to Section 4.15 is a relevant consideration.

A review of the available history for the site gives no indication that the land associated with this development is contaminated. There were no historic uses that would trigger further site investigations.

The objectives outlined within SEPP55 are considered to be satisfied.

STATE ENVIRONMENTAL PLANNING POLICY (VEGETATION IN NON-RURAL AREAS) 2017

State Environmental Planning Policy (Vegetation in Non-Rural Areas) 2017 replaces the repealed provisions of clause 5.9 of SLEP 2012 relating to the preservation of trees and vegetation.

The intent of this SEPP is consistent with the objectives of the repealed Standard where the primary aims/objectives are related to the protection of the biodiversity values of trees and other vegetation on the site.

The proposed development does not result in the removal or loss of any trees or vegetation subject to the provision of this SEPP.

The aims and objectives outlined within the SEPP are considered to be satisfied.

(ii) any draft environmental planning instrument that is or has been placed on public exhibition and details of which have been notified to the consent authority, and

There are no draft planning instruments that are applicable to this site.

(iii) any development control plan,

The proposed development is subject to the provisions of the Strathfield Consolidated Development Control Plan 2005. The following comments are made with respect to the proposal satisfying the objectives and controls contained within the DCP.

Applicable DCP Controls	DCP Controls	Development Proposal	Compliance/ Comment
Fencing			
Height (overall/piers):	1.5m (maximum)	1.5m	Compliant
Solid Component:	0.7m	0.55	Compliant

Landscaping and Open Space

The proposed development does not include any landscape changes.

Fencing

Fence height does not exceed 1.5m in height and the solid component is less than the maximum 0.7m. Brick piers over 1m are proposed and are distributed evenly along the front boundary. Side fencing forward of the building line maintains the height of the front fence.

The proposed front and side fencing satisfies the relevant objectives and controls within SCDCP 2005. It is considered to be sympathetic to the existing and desired character of the locality and is compatible to the height and style of adjoining fences.

Cut and fill

The proposed development is considered to satisfy the relevant objectives and controls of the SCDCP 2005, in that the need for cut and fill has been kept to a minimum and existing ground levels have been maintained where appropriate to reduced site disturbance. Existing trees and shrubs have been retained where possible and ground water tables are maintained and impact on overland flow and drainage is minimised.

Water and Soil Management

The proposed development satisfies the relevant objectives and controls of the SCDCP 2005 and complies with Council's Stormwater Management Code. A soil erosion plan has

been submitted with the application to prevent or minimise soil disturbances during construction.

Access, Safety and Security

The proposed development satisfies the relevant objectives and controls of the SCDP 2005. Separate pedestrian and vehicle access provisions are provided, passive surveillance of the public street has been provided providing safety and perception of safety in the street.

PART H – Waste Management (SCDCP 2005)

A waste management plan will be conditioned to be provided prior to receiving construction certificate. The plan will detail measures for waste during construction.

(iv) *Any matters prescribed by the regulations, that apply to the land to which the development application relates,*

The requirements of Australian Standard AS2601–1991: *The Demolition of Structures* is relevant to the determination of a development application for the demolition of a building.

The proposed development does not involve the demolition of a building.

(b) *the likely impacts of that development, including environmental impacts on both the natural and built environments, and social and economic impacts in the locality,*

The proposed development is of a scale and character that is in keeping with other developments being constructed in the locality. Accordingly, the proposal is not considered to have a significant impact on the natural and built environment or any negative social or economic impacts on the locality.

(c) *the suitability of the site for the development,*

It is considered that the proposed development is of a scale and design that is suitable for the site having regard to its size and shape, its topography, vegetation and relationship to adjoining developments.

(d) *any submissions made in accordance with this Act or the regulations,*

In accordance with the provisions of Councils Community Participation Plan, the application was not notified.

(e) *the public interest.*

The proposed development is of a scale and character that does not conflict with the public interest.

Local Infrastructure Contributions

Section 7.13 of the EP&A Act 1979 relates to the collection of monetary contributions from applicants for use in developing key local infrastructure. This section prescribes in part as follows:

A consent authority may impose a condition under section 7.11 or 7.12 only if it is of a kind allowed by, and is determined in accordance with, a contributions plan (subject to any direction of the Minister under this Division).

Based on the Cost of Works of \$19,000.00 and in accordance with Council's s7.12 Indirect Contributions Plan, a contribution is not required.

Conclusion

The application has been assessed having regard to the Heads of Consideration under Section 4.15 (1) of the *Environmental Planning and Assessment Act 1979*, the provisions of the SLEP 2012 and SCDP 2005.

Following detailed assessment it is considered that Development Application No. DA2021/192 should be approved subject to conditions.



Signed:

**L Fanayan
Planner**

Date: 29/09/2021

- ☒ I confirm that I have determined the abovementioned development application with the delegations assigned to my position;
- ☒ I have reviewed the details of this development application and I also certify that Section 7.11/7.12 Contributions are not applicable to this development;

Report and recommendations have been peer reviewed and concurred with.



Signed:

**Jake Brown
Planner**

Date: 5/10/2021

The following conditions of consent are imposed for the following reasons:

- (a) To ensure compliance with the terms of the relevant Environmental Planning Instrument and/or Building Code of Australia and/or Council's codes, policies and specifications.
- (b) To protect the environment.
- (c) To ensure that there is no unacceptable impact on the amenity of the area, or to private and public property.
- (d) It is in the public interest.

DEVELOPMENT DETAILS

(1) Approved Plans & Documentation

The development must be implemented in accordance with the approved plans and supporting documentation listed below which have been endorsed by Council's approved stamp, except where marked up on the plans and/or amended by conditions of this consent:

Description	Reference No.	Date	Revision	Prepared by
Front Boundary Fence Elevation	HW_0321_014	29 Sept 2021	-	FCG Landscaping
Construction Details	HW_0321_013	7 Sept 2021	-	FCG Landscaping

SEPRARATE APPROVALS REQUIRED UNDER OTHER LEGISLATION

(2) Section 138 Roads Act 1993 and Section 68 Local Government Act 1993

Unless otherwise specified by a condition of this consent, this Development Consent does not give any approval to undertake works on public infrastructure.

Separate approval is required under Section 138 of the [Roads Act 1993](#) and/or Section 68 of the [Local Government Act 1993](#) for any of the following activities carried out in, on or over a public road (including the footpath) listed below.

An application is required to be lodged and approved prior to the commencement of any of the following works or activities;

- (a) If any excavation is to be supported by the use of below ground (cable) anchors that are constructed under Council's roadways/footways.
- (b) Swinging or hoisting goods over any part of a public road by means of a lift, crane or the like;
- (c) Establishing a "works zone";
- (d) Placing or storing materials or equipment;
- (e) Placing or storing waste containers or skip bins;
- (f) Stormwater & ancillary to public infrastructure on private land
- (g) Erecting a structure or carrying out work

These separate activity approvals (a)-(g) must be obtained and evidence of the approval provided to the Certifying Authority prior to the issue of the Construction Certificate.

- (h) Pumping water from the site into the public road;

- (i) Constructing a vehicular crossing or footpath;
- (j) Digging up or disturbing the surface of a public road (e.g. Opening the road for the purpose of connections to utility providers);
- (k) Stormwater & ancillary works in the road reserve; and
- (l) Pumping concrete from a public road;

These separate activity approvals must be obtained and evidence of the approval provided to the Certifying Authority prior to the activities commencing.

The relevant Application Forms for these activities can be downloaded from Council's website www.strathfield.nsw.gov.au. For further information, please contact Council's Customer Service Centre on (02) 9748 9999.

REQUIREMENTS OF CONCURRENCE, INTEGRATED & OTHER GOVERNMENT AUTHORITIES

(3) Sydney Water – Tap in™

The approved plans must be submitted to a Sydney Water Tap in™ to determine whether the development application will affect Sydney Water's sewer and water mains, stormwater drains and/or easements, and if further requirements need to be met. The approved plans will be appropriately endorsed. For details please refer to 'Plumbing, building and developing' section of Sydney Water's web site at www.sydneywater.com.au then see 'Building', or telephone 13000 TAP IN (1300 082 746). The Certifying Authority must ensure that a Tap in™ agent has appropriately stamped the plans prior to the issue of the Construction Certificate.

PRIOR TO THE ISSUE OF A CONSTRUCTION CERTIFICATE

(4) Fees to be Paid

The fees listed in the table below must be paid in accordance with the conditions of this consent and Council's adopted Fees and Charges applicable at the time of payment (available at www.strathfield.nsw.gov.au).

Payments must be made prior to the issue of the Construction Certificate or prior to the commencement of work (if there is no associated Construction Certificate).

Please contact council prior to the payment of s7.11 or s7.12 Contributions to determine whether the amounts have been indexed from that indicated below in this consent and the form of payment that will be accepted by Council.

A summary of the fees to be paid are listed below:

Fee Type	Fee
GENERAL FEES	
Security Damage Deposit	\$ 630.00
Tree Bond	\$ 3,050.00
Administration Fee for Damage Deposit	\$ 130.00
Administration Fee for Tree Bond	\$ 130.00

General Fees

The fees and charges above are subject to change and are as set out in the version of Council's Schedule of Fees and Charges or as required by other Government Authorities, applicable at the time of payment.

(5) Damage Deposit – Minor Works

In order to insure against damage to Council property the following is required:

- (a) Pay Council, before the issue of the Construction Certificate, a damage security deposit for the cost of making good any damage caused to any Council property as a result of the development: \$630.00
- (b) Pay Council, before the issue of the Construction Certificate, a non-refundable administration fee to enable assessment of any damage and repairs where required: \$130.00
- (c) Submit to Council, before the commencement of work, a photographic record of the condition of the Council nature strip, footpath and driveway crossing, or any area likely to be affected by the proposal.

At the completion of work Council will inspect the public works, and the damage deposit will be refunded in full upon completion of work where no damage occurs. Otherwise the amount will be either forfeited or partly refunded according to the amount of damage.

(6) Site Management Plan

Minor Development

A Site Management Plan detailing all weather access control points, sedimentation controls, waste management plans, fencing, builder's site sheds office, amenities, materials storage and unloading arrangements must be submitted with the application for the Construction Certificate.

(7) Waste Manage Plan (WMP)

Prior to the issue of a Construction Certificate, a Waste Management Plan (WMP) must be submitted and it must comply with the requirements contained within Part H of Strathfield Development Control Plan 2005 (DCP 2005). A WMP will become part of any development consent issued and aims to facilitate better waste management, waste minimization and resource recovery.

The WMP is an important planning document that will not only be utilised as part of the development application process, but during construction and for the ongoing use of the development. The WMP will continue to apply as a working reference for the life of the development.

At least one copy of the WMP is to be available on site at all times during construction. Copies of demolition and construction waste dockets that verify the facility that received the material for recycling or disposal and the quantity of waste received, must be retained on site at all times during construction.

PRIOR TO THE COMMENCEMENT OF WORK (INCLUDING DEMOLITION & EXCAVATION)

(8) Dial Before You Dig

The applicant shall contact “Dial Before You Dig on 1100” to obtain a Service Diagram prior to the issuing of the Construction Certificate. The sequence number obtained from “Dial Before You Dig” shall be forwarded to Council’s Engineers for their records.

DURING CONSTRUCTION

(9) Site Sign – Soil & Erosion Control Measures

Prior to the commencement of works (including demolition and excavation), a durable site sign, issued by Council in conjunction with this consent, must be erected in a prominent location on site. The site sign warns of the penalties which apply to pollution, storing materials on road or footpath and breaches of the conditions relating to erosion and sediment controls. The sign must remain in a prominent location on site up until the completion of all site and building works.

(10) Hours of Construction for Demolition and Building Work

Any work activity or activity associated with the development consent that requires the use of any tools (including hand tools) or any power operated plant and machinery that creates noise on or adjacent to the site shall not be performed, or permitted to be performed, except between the hours of 7.00 am to 5.00 pm, Monday to Friday and 8:00am to 1:00pm on Saturdays. No work or ancillary activity is permitted on Sundays, or Public Holidays.

Where the development involves the use of jack hammers/rock breakers and the like, or other heavy machinery, such equipment may only be used between the hours of 7:00am to 5:00pm Monday to Friday only.

Note: A penalty infringement notice may be issued for any offence.

(11) Ground Levels and Retaining Walls

The ground levels of the site shall not be excavated, raised or filled, or retaining walls constructed on the allotment boundary, except where indicated on approved plans or approved by Council.

(12) Obstruction of Road or Footpath

The use of the road or footpath for the storage of any building materials, waste materials, temporary toilets, waste or skip bins, or any other matter is not permitted unless separately approved by Council under Section 138 of the [Roads Act 1993](#) and/or under Section 68 of the [Local Government Act 1993](#). Penalty infringement Notices may be issued for any offences and severe penalties apply.

OPERATIONAL REQUIREMENTS UNDER THE ENVIRONMENTAL PLANNING & ASSESSMENT ACT 1979

(13) Requirement for a Construction Certificate

The erection of a building must not commence until a Construction Certificate has been issued.

(14) Appointment of a PCA

The erection of a building must not commence until the applicant has:

- (a) appointed a PCA for the building work; and
- (b) if relevant, advised the PCA that the work will be undertaken as an Owner -Builder.

If the work is not going to be undertaken by an Owner - Builder, the applicant must:

- (c) appoint a Principal Contractor to undertake the building work. If residential building work (within the meaning of the [Home Building Act 1989](#)) is to be undertaken, the Principal Contractor must be a holder of a contractor licence; and
- (d) notify the PCA of the details of any such appointment; and
- (e) notify the Principal Contractor of any critical stage inspections or other inspections that are required to be carried out in respect of the building work.

(15) Notice of Commencement

The applicant must give at least two days notice to the Council and the PCA of their intention to commence the erection of a building.

(16) Occupation Certificate

A person must not commence occupation or use of the whole or any part of a new building unless an Occupation Certificate has been issued in relation to the building or part.

PRESCRIBED CONDITIONS

(17) Clause 98 – Building Code of Australia & Home Building Act 1989

Requires all building work to be carried out in accordance with the Building Code of Australia. In the case of residential building work to which the [Home Building Act 1989](#) relates, there is a requirement for a contract of insurance to be in force before any work commences.

(18) Clause 98A – Erection of Signs

Requires the erection of signs on site and outlines the details which are to be included on the sign. The sign must be displayed in a prominent position on site and include the name and contact details of the PCA and the Principal Contractor.

ADVISORY NOTES

1. Review of Determination

Section 8.2 of the Environmental Planning and Assessment Act confers on an applicant who is dissatisfied with the determination of the application the right to lodge an application with Council for a review of such determination. Any such review must however be completed within 6 months from its determination. Should a review be contemplated sufficient time should be allowed for Council to undertake public notification and other processes involved in the review of the determination.

Note: review provisions do not apply to Complying Development, Designated Development, State Significant Development, Integrated Development or any application determined by the Sydney East Planning Panel or the Land & Environment Court.

2. Appeal Rights

Division 8.3 (Reviews and appeals) Part 8 of the Environmental Planning and Assessment Act 1979 confers on an applicant who is dissatisfied with the determination of the application a right of appeal to the Land and Environment Court of New South Wales.

3. Lapsing of Consent

This consent will lapse unless the development is physically commenced within 5 years from the Date of Operation of this consent, in accordance with Section 4.53 of the Environmental Planning and Assessment Act 1979 as amended.

4. Access to NSW Legislations (Acts, Regulations and Planning Instruments)

NSW legislation can be accessed free of charge at www.legislation.nsw.gov.au

5. Disability Discrimination Act

This application has been assessed in accordance with the [Environmental Planning and Assessment Act 1979](#). No guarantee is given that the proposal complies with the [Disability Discrimination Act 1992](#). The applicant is responsible to ensure compliance with this and other anti-discrimination legislation. The [Disability Discrimination Act 1992](#) covers disabilities not catered for in the minimum standards called up in the Building Code of Australia which refers to AS1428.1-Design for Access and Mobility.

6. Stormwater & Ancillary Works – Applications under Section 138 Roads Act and/or Section 68 Local Government Act 1993

To apply for approval under Section 138 of the [Roads Act 1993](#):

- (a) Complete the Works Permit Application Form which can be downloaded from Strathfield Council's Website at www.strathfield.nsw.gov.au.
- (b) In the Application Form, quote the Development Consent No. (DA2021/192) and reference this condition number (e.g. Condition 23)
- (c) Lodge the application form, together with the associated fees at Council's Customer Service Centre, during business hours. Refer to Council's adopted Fees and Charges for the administrative and inspection charges associated with Works Permit applications.

An approval for a new or modified vehicular crossing will contain the approved access and/or alignment levels which will be required to construct the crossing and/or footpath. Once approved, all work shall be carried out by a private contractor in accordance with Council's specifications prior to the issue of an Occupation Certificate.

The developer must meet all costs of the extension, relocation or reconstruction of any part of Council's drainage system (including design drawings and easements) required to carry out the approved development.

7. Site Safety Fencing

Site fencing must be erected in accordance with SafeWork Guidelines, to exclude public access to the site throughout the demolition and/or construction work, except in the case of alterations to an occupied dwelling. The fencing must be erected before the commencement of any work and maintained throughout any demolition and construction work.

A demolition licence and/or a high risk work license may be required from SafeWork NSW (see www.SafeWork.nsw.gov.au).

8. Noise

Council will generally enforce noise related conditions in accordance with the *Noise Guide for Local Government* (<http://www.environment.nsw.gov.au/noise/nglg.htm>) and the *Industrial Noise Guidelines* (<http://www.environment.nsw.gov.au/noise/industrial.htm>) publish by the Department of Environment and Conservation. Other state government authorities also regulate the [Protection of the Environment Operations Act 1997](#).

Useful links relating to Noise:

- (a) Community Justice Centres—free mediation service provided by the NSW Government (www.cjc.nsw.gov.au).
- (b) Department of Environment and Conservation NSW, Noise Policy Section web page (www.environment.nsw.gov.au/noise).
- (c) New South Wales Government Legislation home page for access to all NSW legislation, including the *Protection of the Environment Operations Act 1997* and the *Protection of the Environment Noise Control Regulation 2000* (www.legislation.nsw.gov.au).
- (d) Australian Acoustical Society—professional society of noise-related professionals ([www.acoustics.asn.au /index.php](http://www.acoustics.asn.au/index.php)).
- (e) Association of Australian Acoustical Consultants—professional society of noise related professionals (www.aaac.org.au).
- (f) Department of Gaming and Racing - (www.dgr.nsw.gov.au).

9. Australia Post – Letter Box Size and Location

The size and location of letterboxes servicing the development are to comply with the requirements and standard of Australia Post (see attached link: https://auspost.com.au/content/dam/auspost_corp/media/documents/Appendix-02.pdf)