

Project Title
L.017, 38-40. ALBERT Rd, STRATHFIELD

Drawing title
SECTION 01

Scale
 1/50
 Date
 06. 2015

Drawn by
 DS
 Checked by
 MJ

Designed by
 DS
 Approved by
 MJ

Drawing No.
 S101
 Sheet no
 009

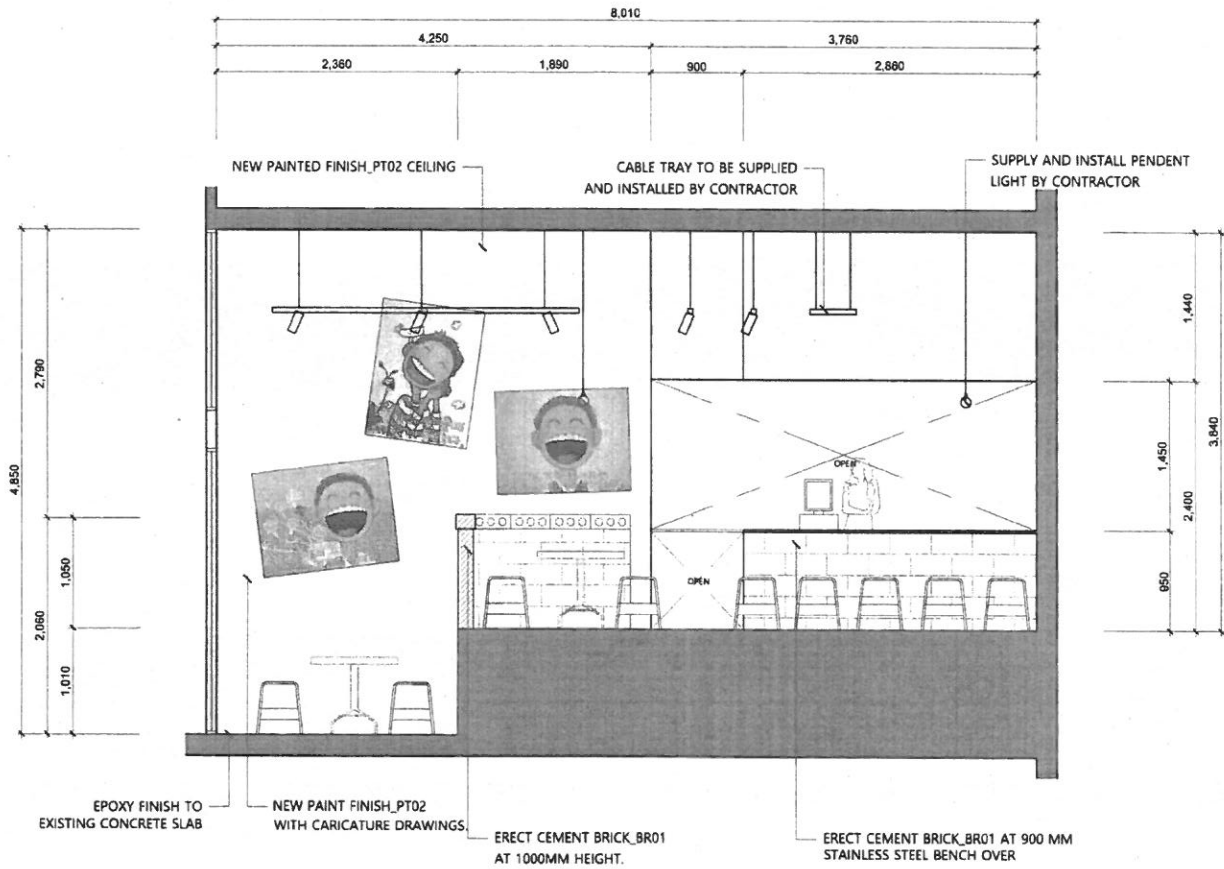

CERTIS NSW PTY LTD
 CDC no: 3782
 APPROVED
 3-July-2015
 Certifying Authority: Tony Griffin
 Accreditation No: BPB 2373



LEMNIX ARCHITECTURE
 1/100-110/112 ALBERT RD, STRATHFIELD NSW 1588
 TEL: (02) 9647 8888
 WWW.LEMNIX.COM.AU
 ARCHITECTS
 1/100-110/112 ALBERT RD, STRATHFIELD NSW 1588
 TEL: (02) 9647 8888
 WWW.LEMNIX.COM.AU
 ARCHITECTS

Project Title
L.017, 38-40. ALBERT Rd, STRATHFIELD

Drawing title
SECTION 02

Scale
 1/50
 Date
 06. 2015

Drawn by
 DS
 Checked by
 MJ

Designed by
 DS
 Approved by
 MJ

Drawing No.
 S102
 Sheet no
 010

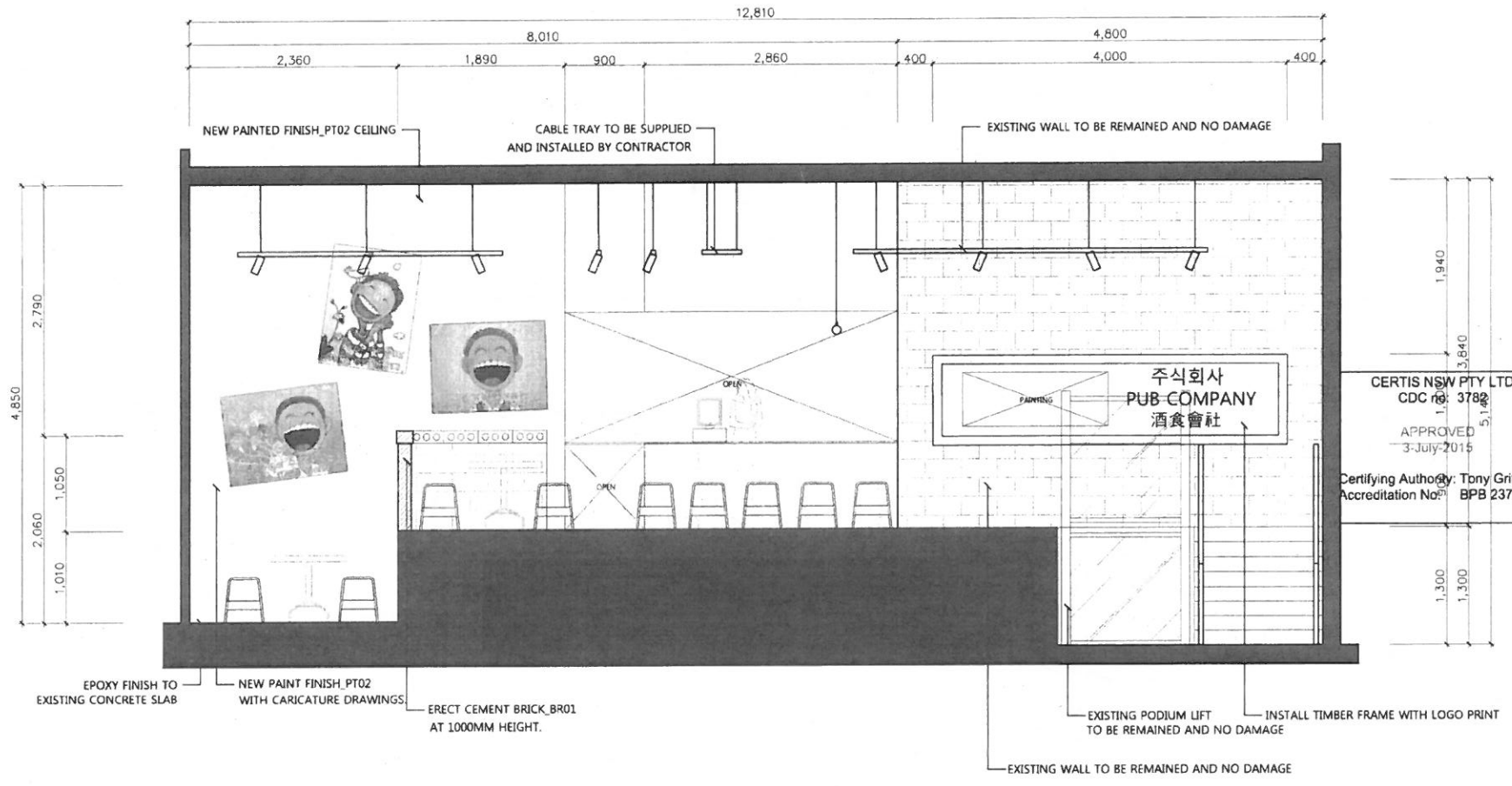

CERTIS NSW PTY LTD
 CDC no: 3782
 APPROVED
 3 July 2015
 Certifying Authority: Tony Griffin
 Accreditation No: BPB 2373

	<p><small>Project Title</small> L.017, 38-40. ALBERT Rd, STRATHFIELD</p>	<p><small>Drawing title</small> SECTION 03</p>	<p>Scale 1/50</p>	<p>Drawn by DS</p>	<p>Designed by DS</p>	<p>Drawing No. S103</p>
			<p>Date 06. 2015</p>	<p>Checked by MJ</p>	<p>Approved by MJ</p>	<p>Sheet no 011</p>

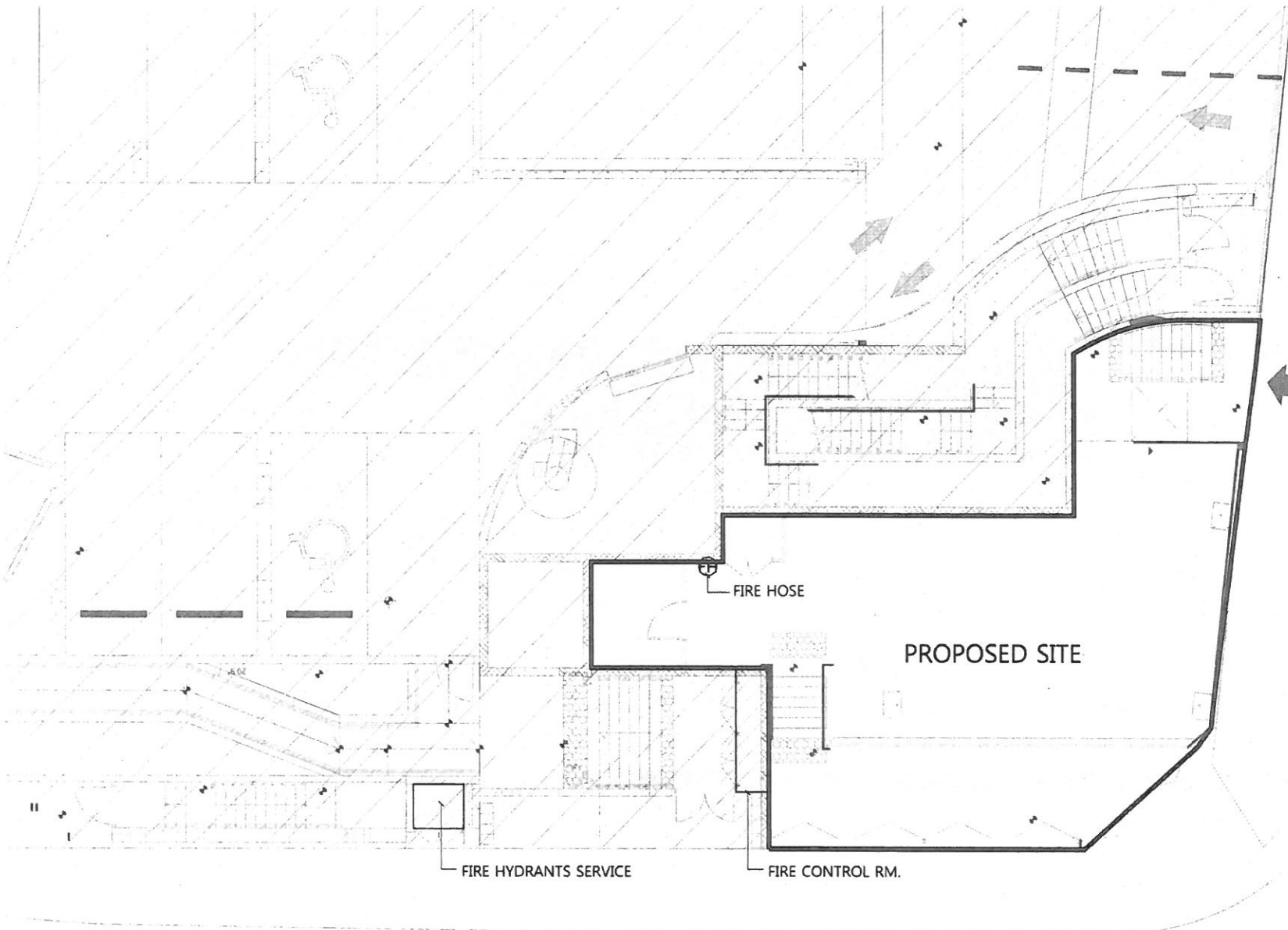

ALBERT ROAD

CERTIS NSW PTY LTD
 CDC no: 3782
 APPROVED
 3-July-2015
 Certifying Authority: Tony Griffin
 Accreditation No: BPB 2373

RAW SQUARE



General Note:
 1. Do not alter any figure dimensions or to be followed.
 2. Copyright of these drawings and/or documents reserved to the designer.
 3. All dimensions are to be confirmed on site by qualified persons only, including all those not indicated on the approved drawings.
 4. In the event of conflicting or inconsistent information, the designer's specifications or notes shall prevail over the manufacturer's specifications, the manufacturer's drawings, the manufacturer's data sheets, and any code.
 5. It is the contractor's responsibility to ensure approval for materials used in accordance with the drawings and other notes to all work to be carried out.
 6. Responsibility for the fabrication of materials to standards set out in these drawings, details, material specifications, and other notes remains with the contractor.
 7. The contractor shall be responsible for all work and materials to be used in the work as shown.
 8. The contractor shall be responsible for all work and materials to be used in the work as shown.
 9. The contractor shall be responsible for all work and materials to be used in the work as shown.

Project Title
L.017, 38-40. ALBERT Rd, STRATHFIELD

Drawing title
SITE PLAN

Scale	1/100	Drawn by	DS	Designed by	DS	Drawing No.	SP100
Date	06. 2015	Checked by	MJ	Approved by	MJ	Sheet no	003